

TYLER COUNTY COMMISSIONERS COURT  
REGULAR MEETING  
April 10, 2000 ---- 10:00 a.m.

THE STATE OF TEXAS                      ON THIS THE 10<sup>th</sup> day of April, 2000 the  
Commissioners' Court in and for Tyler County, Texas convened in a Regular Meeting at  
the Commissioners' Courtroom in Woodville, Texas, the following members of the Court  
present, to wit:

MAXIE L. RILEY	COMMISSIONER, PCT. #1, presiding
RUSTY HUGHES	COMMISSIONER, PCT. #2
JOE MARSHALL	COMMISSIONER, PCT. #3
HENRY EARL SAWYER	COMMISSIONER, PCT. #4
DONECE GREGORY	COUNTY CLERK, EX OFFICIO

The following were absent: Judge Owens thereby constituting a quorum. In addition to  
the above were:

JOYCE MOORE    COUNTY AUDITOR

A motion was made by Commissioner Riley and seconded by Commissioner Sawyer to  
approve the minutes of March 17, 2000. All voted yes and none no.

**Commissioner Sawyer** motioned to table approval of the **County Treasurer's monthly  
reports** for February and March until Friday. **Commissioner Marshall** seconded the  
motion. All voted yes and none no.

A motion was made by **Commissioner Sawyer** to approve the **County Probation  
monthly reports**, both adult and juvenile departments. **Commissioner Marshall**  
seconded the motion. All voted yes and none no. SEE ATTACHED REPORTS.

**Commissioner Hughes** motioned to accept the **monthly report of the Justice of Peace,  
Pct. #1**. **Commissioner Sawyer** seconded the motion. All voted yes and none no. SEE  
ATTACHED REPORT.

A motion was made by **Commissioner Marshall** to accept the **monthly report of the  
County Clerk**. **Commissioner Sawyer** seconded the motion. All voted yes and none  
no. SEE ATTACHED REPORT.

A motion was made by **Commissioner Marshall** and seconded by **Commissioner  
Hughes** to approve the monthly report of Sherry Gardner from the County Extension  
Department. Matt's report was not available; his was tabled. All voted yes and none no.  
SEE ATTACHED REPORT.

COMMISSIONERS' COURT

April 10, 2000

**Commissioner Hughes** made a motion to table approval of the **County Auditor's monthly report** until Friday, April 14th. **Commissioner Sawyer** seconded the motion. All voted yes and none no.

A motion was made by **Commissioner Marshall** to approve the allowances and accounts payable as submitted by the County Auditor. **Commissioner Sawyer** seconded the motion. All voted yes and none no. SEE ATTACHED

Judge Riley presented the Load Posting Agreement with the **Texas Department of Transportation** for bridges in the county. **Commissioner Marshall** motioned and seconded by **Commissioner Sawyer** to approve the agreement and authorize Judge Owens to execute it. All voted yes and none no. SEE ATTACHED AGREEMENT.

**Commissioner Marshall** motioned to authorize up to \$3000 for payment to Graham Luhn, architect for the courthouse preservation master plan and grant application. This will be paid out of the contingency fund. **Commissioner Sawyer** seconded the motion. All voted yes and none no.

A motion was made by **Commissioner Hughes** and seconded by **Commissioner Sawyer** to reappoint Ona Lee Seamans, Dr. Bob Swearingen and James Harold Brown to the **Tyler County Hospital Board**; and, appoint Tommy Hamilton to fill the unexpired term of Allen Bell. All voted yes and none no. Mrs. Seamans indicated the merger of the hospital to Memorial of Lufkin, in order to maintain the quality of the hospital and that it remain open for the citizens of the county.

A motion was made by **Commissioner Hughes** to approve the giving of an easement to Thomas Taylor for access to his property off CR2015, near the airport in Precinct #2. **Commissioner Sawyer** seconded the motion. All voted yes and none no. SEE ATTACHED FIELD NOTES.

A motion was made by **Commissioner Marshall** and seconded by **Commissioner Sawyer** to approve the purchase, up to \$300, of 35mm cameras for three patrol cars of the **Department of Public Safety**, as requested by Officer Bill Lohmann. The DPS department will continue to furnish the film. The cameras will be used for crime scenes and fatalities. All voted yes and none no. This purchase will be paid from the contingency fund.

Ted Lukeman previously with PEBSCO indicated that PEBSCO no longer wanted to administer small accounts of deferred compensation 457 plans. He presented a proposal from COPELAND. Since this was not an agenda item. No action was discussed or taken.

COMMISSIONERS' COURT  
April 10, 2000

Marjorie Schultz announced the formation of Tyler County Interfaith Outreach Network and their implementation of the Rainbow Room for children through Child Protective Services.

Commissioner Sawyer motioned the meeting adjourned.

THERE BEING NO FURTHER BUSINESS, THE MEETING ADJOURNED 11:00 a.m.

SIGNED: \_\_\_\_\_ Jerome Owens, County Judge

Maxie L. Riley Maxie L. Riley, Comm. Pct. #1

\_\_\_\_\_ Rusty Hughes, Comm. Pct. #2

Joe Marshall Joe Marshall, Comm. Pct. #3

Henry Earl Sawyer Henry Earl Sawyer, Comm. Pct. #4

ATTEST: Donece Gregory Donece Gregory, County Clerk



EARL B. STOVER, III  
District Judge  
MONTE D. LAWLIS  
District Judge  
JEROME P. OWENS, JR.  
County Judge

## TYLER COUNTY JUVENILE PROBATION DEPARTMENT

100 West Bluff - Room A003  
Woodville, Texas 75979  
(409) 283-2503

TERRY ALLEN  
Chief Probation Officer  
TONYA SHEFFIELD  
Juvenile Probation Officer  
KATHY HARRIS  
Secretary

### JUVENILE PROBATION REPORT--MARCH 2000

BEGINNING NUMBER OF JUVENILES	27
NEW CASES THIS MONTH	2
TERMINATIONS	4
TOTAL NUMBER ON PROBATION	25
CRISIS INTERVENTION	3

Respectfully submitted,

A handwritten signature in cursive script that reads "Terry Allen".

Terry Allen  
Chief Juvenile Probation Officer

#### \*Probation fees and Restitution collected for the month of March:

Probation fees	\$	150.00
Restitution (victim) fees	\$	250.00
Restitution (detention) fees	\$	00.00

TYLER COUNTY JUVENILE PROBATION

CHECK COLLECTIONS & FEES  
REPORT

March 2000

Payee	Payor	Receipt	Detention	Restitution	Probation	Total
Prob.	574	#937			15.00	15.00
Prob.	617	938			30.00	30.00
Prob.	766	939			10.00	10.00
Prob.	774	940			5.00	5.00
Rest.	718	941		80.00		80.00
Prob.	746	942			15.00	15.00
Prob. Rest.	708	943		47.50	15.00	62.50
Prob.	572	944			15.00	15.00
Prob.	734	945			30.00	30.00
Prob. Rest.	708	946		42.50	15.00	57.50
Rest.	718	947		80.00		80.00
				\$ 250 <sup>00</sup>	\$ 150 <sup>00</sup>	\$ 400 <sup>00</sup>

MONTHLY COMMUNITY SUPERVISION AND CORRECTIONS REPORT

APR 07 2000

County: Tyler

Report Month/Year: April, 2000 **WENDEE GREGORY, COUNTY CLERK  
TYLER COUNTY, TEXAS**

	FELONY	MISDEMEANOR	TOTAL
<b>I. END OF MONTH SUPERVISION STATUS</b>			
<b>A. Adults Receiving DIRECT Supervision</b>			
	212	130	342
1. Level 1 (CSCD Defined)	0	0	0
2. Level 2 (Maximum Case Classification)	28	9	37
3. Level 3 (Medium Case Classification)	88	104	192
4. Level 4 (Minimum Case Classification)	96	17	113
5. Residential	0	0	0
<b>B. Adults on INDIRECT Status</b>			
	151	154	305
1. Intrastate Transfers (out)	62	35	97
a. Transfers Out of CSCD	62	35	97
b. Transfers Within CSCD	0	0	0
2. Interstate Transfers (out)	9	2	11
3. Absconders	14	48	62
a. New to Absconder Status	1	2	3
4. Report by Mail	0	0	0
5. Inactive Indirects Due to Incarceration	9	0	9
a. Sentenced to County Jail	0	0	0
b. Sentenced to TDCJ-ID	1	0	1
c. Serving Time in a Substance Abuse Felonv Punishment Facility (SAFPF)	8	0	8
d. Sentenced to State Jail	0	0	0
6. Other Indirect	57	69	126
<b>C. Pretrial Services</b>			
	1	5	6
1. Pretrial Supervision (court-approved)	0	0	0
2. Pretrial Diversion	1	5	6
<b>D. Civil Probation</b>			
			0
<b>II. MONTHLY ACTIVITY</b>			
<b>A. Community Supervision Placements</b>			
1. Original Community Supervision Placements	4	28	32
a. Adjudicated Community Supervision	1	14	15
b. Deferred Adjudication	3	14	17
c. Return From:	0	0	0
1) Shock Incarceration	0	0	0
2) State Boot Camp	0	XXXXXXXXXX	0
2. Subsequent Supervision Placements Within the CSCD	0	0	0

MONTHLY COMMUNITY SUPERVISION AND CORRECTIONS REPORT

County: Tyler Report Month / Year: April, 2000

II. MONTHLY ACTIVITY (Contd.)	FELONY	MISDEMEANOR	TOTAL
<b>A. Community Supervision Placements (Contd.)</b>			
3. Transferred in for Supervision	<u>0</u>	<u>1</u>	<u>1</u>
4. Deferred to Adjudicated Status	<u>1</u>	<u>0</u>	<u>1</u>
5. Pretrial Services Placements	<u>0</u>	<u>2</u>	<u>2</u>
a. Pretrial Supervision (court-approved)	<u>0</u>	<u>0</u>	<u>0</u>
b. Pretrial Diversion	<u>0</u>	<u>2</u>	<u>2</u>
<b>B. Community Supervision Subtractions</b>			
1. Supervision Terminations	<u>9</u>	<u>24</u>	<u>33</u>
a. Early Terminations	<u>0</u>	<u>0</u>	<u>0</u>
b. Expired Term of Community Supervision	<u>3</u>	<u>14</u>	<u>17</u>
c. Revoked to County Jail	<u>0</u>	<u>0</u>	<u>0</u>
d. Revoked to State Jail	<u>2</u>	XXXXXXXXXX	<u>2</u>
e. Revoked to TDCJ	<u>1</u>	XXXXXXXXXX	<u>1</u>
1) Institutional Division	<u>1</u>	XXXXXXXXXX	<u>1</u>
2) State Boot Camp	<u>0</u>	XXXXXXXXXX	<u>0</u>
f. Other Revocations	<u>1</u>	<u>0</u>	<u>1</u>
g. Administrative Closures	<u>1</u>	<u>10</u>	<u>11</u>
1) Return of Courtesy Supervision	<u>1</u>	<u>6</u>	<u>7</u>
2) Other Administrative Closures	<u>0</u>	<u>4</u>	<u>4</u>
h. Deaths	<u>1</u>	<u>0</u>	<u>1</u>
i. Pretrial Terminations	<u>0</u>	<u>0</u>	<u>0</u>
2. Reasons for Revocation	<u>4</u>	<u>0</u>	<u>4</u>
a. New Offense Conviction	<u>1</u>	<u>0</u>	<u>1</u>
b. Subsequent Arrest/Offense Alleged in MTR	<u>1</u>	<u>0</u>	<u>1</u>
c. Other	<u>2</u>	<u>0</u>	<u>2</u>
<b>C. Presentence Investigations Completed (TDCJ-CJAD-approved format)</b>			
	<u>3</u>	<u>0</u>	<u>3</u>

III. TOTAL NUMBER OF PAID CSCD STAFF WITHIN COUNTY	TOTAL
A. Number of Paid CSOs Employed <i>Full-time</i> within County (40 hours per wk)	<u>5</u>
B. Number of Paid CSOs Employed <i>Part-time</i> within County (less than 40 hours per wk)	<u>0</u>
C. Number of Paid Non-CSOs Employed <i>Full-time</i> within County (40 hours per wk)	<u>2</u>
D. Number of Paid Non-CSOs Employed <i>Part-time</i> within County (less than 40 hours per wk)	<u>3</u>

CERTIFICATION:

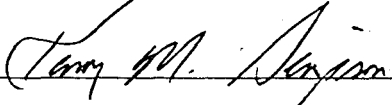
Signature of CSCD Director:  Date: 4-7-00

Signature of District Judge: \_\_\_\_\_ Date: \_\_\_\_\_

MONTHLY COMMUNITY SUPERVISION AND CORRECTIONS REPORT

CSCD: Tyler  
(Specify chief county)

Report Month/Year: April, 2000

RESIDENTIAL FACILITIES MONTHLY ACTIVITY

Facility Category	Facility Type	CJAD Des.	Felons				Misdemeanants			
			BOM	ADD	DEL	EOM	BOM	ADD	DEL	EOM

PROGRAMS AND INTERVENTIONS MONTHLY ACTIVITY

Program or Intervention	Type	Felons				Misdemeanants			
		BOM	ADD	DEL	EOM	BOM	ADD	DEL	EOM

BOM -- Beginning of month count  
ADD -- Additions during the month  
DEL -- Deletions during the month  
EOM -- End of month count



MONTHLY COMMUNITY SUPERVISION AND CORRECTIONS REPORT

STATE JAIL FELONS SUPPLEMENTAL REPORT

County: Tyler Report Month/Year: April, 2000

I. END OF MONTH SUPERVISION STATUS

A. State Jail Felons Receiving DIRECT Supervision	<u>76</u>
B. State Jail Felons on INDIRECT Status	<u>45</u>
1. Intrastate Transfers (out)	<u>24</u>
2. Absconders	<u>3</u>
C. Incarcerated in State Jail	<u>0</u>
1. As an Initial Condition of Community Supervision	<u>0</u>
2. As a Modification of Community Supervision	<u>0</u>
D. Incarcerated in County Jail	<u>0</u>
E. Incarcerated in a Substance Abuse Felony Punishment Facility (SAFPF)	<u>3</u>

II. MONTHLY ACTIVITY

A. Original Community Supervision Placements	
1. Community Supervision Placements Direct from the Courts	<u>4</u>
a. Number that Received Up-Front State Jail Time as an Initial Condition of Community Supervision	<u>0</u>
b. Number that Received Post-Sentencing (disposition) Up-Front County Jail Time as an Initial Condition of Community Supervision.	<u>0</u>
2. Return from Shock Incarceration	<u>0</u>
B. Community Supervision Subtractions (Supervision Terminations)	<u>3</u>
C. Modifications of Community Supervision to State Jail	<u>0</u>

4/07/00  
11:47:14

TYLER COUNTY COMMUNITY SUPERVISION & CORRECTIONS  
CSR PERFORMED  
FOR PERIOD 3/01/00 THRU 3/31/00

PAGE 1

COUNTY: 229 - TYLER COUNTY

<u>RECIPIENT NAME</u>	<u>ID#</u>	<u>CAUSE#</u>	<u>PROBATIONER NAME</u>	<u>DATE</u>	<u>HOURS</u>
HOURS TRANSFERRED IN	14717	14717	YANCEY, CARROLL	3/11/00	4:00
	14717	14717	YANCEY, CARROLL	3/12/00	8:00
	99297	99297	LEWING, LEAMON CARL	3/13/00	80:00
			TOTAL HOURS =		92:00
ORCHARD/TYLER CO. HOSPITAL	8480	8480	OVERSTREET, CRAIG	3/17/00	8:00
	28955	28955	MOORE, PHILLIP WAYNE	3/17/00	8:00
	75796	75796	GRIHES, HAROLD LYNN JR	3/17/00	8:00
			TOTAL HOURS =		24:00
TYLER CO. AIRPORT	97549	9979	WALES, JEFFERY WADE	3/15/00	8:00
			TOTAL HOURS =		8:00

TYLER CO. COLLECTION CENTER	8721	8721	STERLING, ROGER	3/01/00	10:00
	8721	8721	STERLING, ROGER	3/02/00	10:00
	8721	8721	STERLING, ROGER	3/03/00	10:00
	8721	8721	STERLING, ROGER	3/04/00	8:00
	8721	8721	STERLING, ROGER	3/06/00	10:00
	8721	8721	STERLING, ROGER	3/09/00	10:00

TOTAL HOURS = 58:00

TYLER CO. COURTHOUSE	11	11	ABRAM, CARDRICK	3/22/00	8:00
	55	55	COUCH, JOSEPH	3/18/00	8:00
	7343	0079	BROWN, JOE KELVIN	3/22/00	8:00
	7343	0079	BROWN, JOE KELVIN	3/23/00	8:00
	7921	8903	EASON, FRANK GILBERT	3/02/00	4:30
	8003	3003	BEATY, REMONA RENEE	3/08/00	2:00
	8331	8331	MARTIN, LESTER WILBURN	3/01/00	5:00
	8370	8370	HADNOT, ARVESTA	3/21/00	8:00
	8464	08464	GRIFFITH, RICHARD E	3/02/00	8:00
	8464	08464	GRIFFITH, RICHARD E	3/09/00	8:00
	8464	08464	GRIFFITH, RICHARD E	3/10/00	8:00
	8472	8472	DIANNI, ARMON	3/18/00	8:00
	8480	8480	OVERSTREET, CRAIG	3/14/00	4:30
	8480	8480	OVERSTREET, CRAIG	3/15/00	4:30
	8480	8480	OVERSTREET, CRAIG	3/21/00	4:30
	8482	8482	TIMMERMAN, WILLIAM	3/18/00	4:30
	8504	8504	HAYNES, ERNEST JR	3/01/00	8:00
	8504	8504	HAYNES, ERNEST JR	3/02/00	8:00
	8504	8504	HAYNES, ERNEST JR	3/03/00	8:00
	8504	8504	HAYNES, ERNEST JR	3/06/00	8:00
	8504	8504	HAYNES, ERNEST JR	3/08/00	8:00
	8504	8504	HAYNES, ERNEST JR	3/09/00	8:00
	8504	8504	HAYNES, ERNEST JR	3/10/00	8:00
	8504	8504	HAYNES, ERNEST JR	3/15/00	8:00
	8673	9103	LEE, DENNIS WAYNE	3/17/00	8:00
	8673	9103	LEE, DENNIS WAYNE	3/31/00	8:00
	8829	8829	UNSWORTH, WENDY	3/18/00	8:00
	8861	8861	KING, BRAD	3/02/00	4:00
	8861	8861	KING, BRAD	3/06/00	7:00
	8861	8861	KING, BRAD	3/14/00	4:30
	8861	8861	KING, BRAD	3/27/00	8:00
	9041	9041	SMITH, CHEVIS JARONE	3/02/00	7:00
	9978	9978	JONES, CECIL COY	3/14/00	8:00
	14837	14837	WEST, VICKIE CHARLENE	3/20/00	2:00
	30633	30633	RODRIGUEZ, CHARLES	3/30/00	8:00
	75796	75796	GRIMES, HAROLD LYNN JR	3/01/00	4:30

4/07/00  
11:47:14

TYLER COUNTY COMMUNITY SUPERVISION & CORRECTIONS  
CSR PERFORMED  
FOR PERIOD 3/01/00 THRU 3/31/00

PAGE 2

COUNTY: 229 - TYLER COUNTY

<u>RECIPIENT NAME</u>	<u>ID#</u>	<u>CAUSE#</u>	<u>PROBATIONER NAME</u>	<u>DATE</u>	<u>HOURS</u>
	79857	79857	JOHNSON, CYNTHIA LOUISE	3/09/00	8:00
	79857	79857	JOHNSON, CYNTHIA LOUISE	3/14/00	8:00
	88600	88600	GARDNER, DAVID	3/22/00	8:00
	88600	88600	GARDNER, DAVID	3/25/00	4:00
	96112	96112	HAFFORD, RENEE	3/01/00	6:00
	96112	96112	HAFFORD, RENEE	3/03/00	7:30
	96112	96112	HAFFORD, RENEE	3/06/00	8:00
	96112	96112	HAFFORD, RENEE	3/07/00	7:30
	97549	9979	WALES, JEFFERY WADE	3/14/00	4:30
	98414	9940	SCOTT, JIMMY	3/20/00	7:00
	99208	99208	HOWARD, IESHA	3/31/00	8:00
	99258	99258	MCKINNON, DANA	3/18/00	2:00
	99299	99299	HARDEN, TWILA	3/18/00	4:30
	99307	99307	DEAN, PATRICK	3/06/00	4:30
			TOTAL HOURS =		330:00
TYLER CO. COURTHOUSE ANNEX	8464	08464	GRIFFITH, RICHARD E	3/07/00	8:00
	8504	8504	HAYNES, ERNEST JR	3/07/00	8:00
	9041	9041	SMITH, CHEVIS JARONE	3/06/00	7:30
			TOTAL HOURS =		23:30
TYLER CO. DOGWOOD PROGRAM	11	11	ABRAM, CARDRICK	3/28/00	7:30
	55	55	COUCH, JOSEPH	3/11/00	4:00
	6411	213809	HOLCOMB, ROGER DALE	3/13/00	8:00
	7343	0079	BROWN, JOE KELVIN	3/18/00	8:00
	8370	8370	HADNOT, ARVESTA	3/30/00	8:00
	8370	8370	HADNOT, ARVESTA	3/31/00	8:00
	8472	8472	DIANNI, ARMON	3/11/00	4:00
	8480	8480	OVERSTREET, CRAIG	3/13/00	4:30
	8673	95164	LEE, DENNIS WAYNE	3/11/00	8:00
	8861	8861	KING, BRAD	3/28/00	8:00

86340	86340	WHITEHEAD, JOHN R	3/11/00	4:30
93163	7784	FERCHAU, JAY ALLEN	3/11/00	4:30
960146	960146	GAIN, THOMAS GERALD	3/28/00	8:00

TOTAL HOURS = 93:00

TYLER CO. HOSPITAL

11	11	ABRAM, CARDRICK	3/21/00	7:00
8482	8482	TIMMERMAN, WILLIAM	3/04/00	8:00
8673	9103	LEE, DENNIS WAYNE	3/04/00	8:00
8673	9103	LEE, DENNIS WAYNE	3/29/00	8:00
8742	8743	STANFORD, BRADLEY	3/21/00	4:00
8861	8861	KING, BRAD	3/03/00	8:00
9041	9041	SMITH, CHEVIS JARONE	3/03/00	8:00
13429	13429	RICHARDSON, JOHNNY	3/04/00	8:00
99216	99216	RIGSBY, BYRON EARL	3/29/00	4:30

TOTAL HOURS = 63:30

TYLER CO. NUTRITION CENTER

8861	8861	KING, BRAD	3/01/00	4:30
8861	8861	KING, BRAD	3/09/00	3:30
9041	9041	SMITH, CHEVIS JARONE	3/01/00	4:30
9041	9041	SMITH, CHEVIS JARONE	3/09/00	3:30
75796	75796	GRIMES, HAROLD LYNN JR	3/02/00	8:00
97549	9979	WALES, JEFFERY WADE	3/02/00	4:00
97549	9979	WALES, JEFFERY WADE	3/06/00	4:30

TOTAL HOURS = 32:30

4/07/00  
11:47:14

TYLER COUNTY COMMUNITY SUPERVISION & CORRECTIONS  
CSR PERFORMED  
FOR PERIOD 3/01/00 THRU 3/31/00

PAGE 3

COUNTY: 229 - TYLER COUNTY

RECIPIENT NAME	ID#	CAUSE#	PROBATIONER NAME	DATE	HOURS
TYLER CO. PCT#1	8861	8861	KING, BRAD	3/07/00	6:00
	9041	9041	SMITH, CHEVIS JARONE	3/07/00	4:00
	75796	75796	GRIMES, HAROLD LYNN JR	3/07/00	8:00

TOTAL HOURS = 18:00

TYLER CO. RODEO ARENA	8367	8367	BROWN, SAMUEL D	3/29/00	4:30
	8370	8370	HADNOT, ARVESTA	3/23/00	8:00
	8861	8861	KING, BRAD	3/23/00	8:00
	8861	8861	KING, BRAD	3/27/00	4:30
	8913	8913	DIVINS, JESSE J	3/18/00	8:00
	89575	7707	KIRKWOOD, RICKEY BERNARD	3/18/00	8:00
	98431	98431	CHANDLER, ROBERT	3/18/00	4:30

TOTAL HOURS = 45:30

TYLER CO. WOMENS SHELTER	8857	8857	CASEL, LUSHUNDA	3/08/00	8:00
	79857	79857	JOHNSON, CYNTHIA LOUISE	3/08/00	8:00
	79857	79857	JOHNSON, CYNTHIA LOUISE	3/21/00	8:00
	79857	79857	JOHNSON, CYNTHIA LOUISE	3/22/00	5:30
	79857	79857	JOHNSON, CYNTHIA LOUISE	3/29/00	6:30
	87100	87100	ROBINSON, ELWONDA	3/12/00	4:00
	87100	87100	ROBINSON, ELWONDA	3/23/00	4:00
	97116	8753	LYLES, STEPHANIE	3/22/00	8:00
	97116	8753	LYLES, STEPHANIE	3/23/00	8:00
	99208	99208	HOWARD, IESHA	3/28/00	8:00
	99208	99208	HOWARD, IESHA	3/29/00	8:00
	99299	99299	HARDEN, TWILA	3/20/00	6:30
	99299	99299	HARDEN, TWILA	3/22/00	5:30
	99320	99320	SEARS, LESLIE SHAMIEKA DANIELS	3/08/00	8:00
	99320	99320	SEARS, LESLIE SHAMIEKA DANIELS	3/15/00	5:30
	915511	915511	GONZALES, KATRINA	3/15/00	5:30

TOTAL HOURS = 107:00

TYLER CO. WOODWORK PROGRAM	99251	99251	BUMSTEAD, ROBERT	3/06/00	32:00
----------------------------	-------	-------	------------------	---------	-------

TOTAL HOURS = 32:00

TOTAL HOURS SERVED FOR PERIOD = 927:00

*Done*

MONTHLY REPORT FOR THE MONTH OF MARCH, 2000

RECEIPTS:

TOTAL MONTHLY DEPOSIT	\$ 8943.75
BREAK-DOWN OF RECEIPTS	
COUNTY SHARE OF FINES	\$ 5100.72
CIVIL FEES	40.00
DSC FEES	80.00
COUNTY REGISTRAR FEES	327.00
MISC.	-0-

NO. \_\_\_\_\_ TIME \_\_\_\_\_

APR 05 2000

DONECE GREGORY, COUNTY CLERK  
TYLER COUNTY, TEXAS

TOTAL OF THOSE LISTED ABOVE FOR GENERAL FUND	\$ 5547.72
RAILROAD COMMISSION	-0-
PARKS & WILDLIFE - P&W	225.00
JUDICIAL & COURT PERSONNEL TRAINING - JCPT (&CPT)	87.28
LAW ENFORCEMENT OFFICER'S STANDARDS & EDUCATION - LEOSE&CE	-0-
LAW ENFORCEMENT MANAGEMENT INSTITUTE - LEMI	-0-
LAW ENFORCEMENT OFFICER'S ADMINISTRATIVE - LEOA	-0-
CRIMINAL JUSTICE PLANNING - CVC	812.44
CRIMINAL JUSTICE PLANNING - CJP	-0-
OPERATOR'S & CHAUFFEUR'S LICENSE - OCL	-0-
COMPREHENSIVE REHABILITATION - CR	-0-
GENERAL REVENUE - GR	-0-
CHILD SAFETY-CS; OR BAT (CS)	-0-
TRAFFIC - TFC	134.54
ARREST FEE #1; S/O-\$30.95 State-\$229.88	260.83
ARREST FEE #2; S/O-\$ STATE \$205.00	205.00
CONSOLIDATED COURT COST - CCC	920.79
JUVENILE CRIME & DELINQUENCY - JCD	13.54
FUGITIVE APPREHENSION - FA	270.84
COURTHOUSE SECURITY - CHS	162.50
TRAFFIC LAW FAILURE TO APPEAR - TLFTA	-0-
TIME PAYMENT - TP	295.27
SFF - INDIGENT LEGAL STATE FEE FOR CIVIL	8.00

MISC.

TOTAL RECEIPTS:

BEGINNING BALANCE \$ -0- BANK \$ 8943.75

NO CASES DISPOSED OF 66 NO OF INQUEST 3  
 NO CRIMINAL CASES FILED 68  
 CRIMINAL JUSTICE CASES FILED 3  
 CIVIL CASES FILED 2 SMALL CLAIMS CASES FILED 5  
 FED CASES FILED 0 STATUARY WARNINGS 30  
 EMERGENCY MENTAL 1

*Wanda Brasher*

JUSTICE OF THE PEACE, PCT. #1  
TYLER COUNTY

FEE CODE	FEE DESCRIPTION	GL ACCOUNT	COLLECTED	REFUNDS	LIABILITY
	TOTAL DEPT				
	TOTAL FUND				
JF	Judicial Fund - Salary, etc	state	775.00		775.00
	TOTAL DEPT				775.00
	TOTAL FUND				775.00
RESTI	Restitution	COCLK TRUST	1,517.32		1,517.32
STATB	Comptroller Fees for Birth Certific	COCLK TRUST	113.40		113.40
STATE	Childrens Trust Fund (State)	COCLK TRUST	248.00		248.00
	TOTAL DEPT				1,878.72
	TOTAL FUND				1,878.72
BCLSI	Basic Civil Legal Servs f/ Indigent	ST & Co5X	80.00		80.00
	TOTAL DEPT				80.00
	TOTAL FUND				80.00
ADMNB	administrative cost for birth certif	10	12.60		12.60
APATY	Court Appointed Attorney Fees	10	280.75		280.75
BIRTH	Birth Certificates	10	567.00		567.00
CERTF	Certification Fees	10	145.00		145.00
CLERK	MISC Clerk Fees	10	48.00		48.00 + 6.00 = 54.00
COATY	County Attorney Fees	10	370.00		370.00
COPYS	Copies	10	1,675.00		1,675.00
CRCLK	Criminal Clerk Fees	10	550.50		550.50
CRSO	Criminal Sheriff Fees	10	240.00		240.00
CSERV	fee in lieu of community service	10	300.00		300.00
CVCLK	Civil Clerk Fees	10	60.00		60.00
DEATH	Death Certificates	10	159.00		159.00
HARRI	Copies of Marriage License	10	70.00		70.00
ML	Marriage Liscense	10	232.00		232.00
PRCLK	Probate Clerk Fees	10	739.00		739.00
PRJUD	Probate Judge Fees	10	71.00		71.00
PRSD	Probate Sheriff Fess	10	180.00		180.00
RECRD	Recording Fees	10	4,475.50		4,475.50
UCC	Uniform Commercial Code Filing Fees	10	379.00		379.00
	TOTAL DEPT				10,554.35
	TOTAL FUND				10,554.35
					6.00
					10,560.35

REPORT: FEES EARNED AND COLLECTIONS MADE  
DONECE GREGORY - COUNTY CLERK

MONTH OF March, 2000.

	EARNED	STATE COMPTROLLER	TRUST
TOTALS	\$21,967.85	\$2,468.40	\$1,517.32

Subscribed & sworn to before me on the 10 day of April, 2000

*Donece Gregory*  
DONECE GREGORY  
Tyler County Clerk

Check to Co. Treasurer:

County Funds	21,967.85
State Funds	1,332.00
Interest Earned	37.27
<b>Total</b>	<b>23,337.12</b>

Clerk Records Management Fees	RMPCK	2,768.50
Courthouse Records Management Fees	RMPCO	200.00
Probate Judicial Education	PRJED	65.00
Courthouse Security (CHS)		679.00

STATE COMPTROLLER FEES  
(reported by County Clerk)

STATE (Childrens Trust Fund):	248.00
STATEB (birth certificates):	113.40
RESTITUTION:	1,517.32
JF (Judicial Salary Fund)	775.00



FEE CODE	FEE DESCRIPTION	GL ACCOUNT	COLLECTED	REFUNDS	LIABILITY
FINE	Fines	10 and 20	7,395.00		<u>7,395.00</u>
	TOTAL DEPT				<u>7,395.00</u>
	TOTAL FUND				<u>7,395.00</u> *
PRJED	Probate Judicial Education Fees	1040122	65.00		<u>65.00</u>
	TOTAL DEPT				<u>65.00</u>
	TOTAL FUND				<u>65.00</u>
RMPCK	Clerk Records Management Fees	31	2,768.50		<u>2,768.50</u>
	TOTAL DEPT				<u>2,768.50</u>
	TOTAL FUND				<u>2,768.50</u>
CVLAW	Civil Law Library Fees	36	40.00		<u>40.00</u>
PRLAW	Probate Law Library Fees	36	260.00		<u>260.00</u>
	TOTAL DEPT				<u>300.00</u>
	TOTAL FUND				<u>300.00</u>
CHS	Courthouse Security Fees	44	679.00		<u>679.00</u>
	TOTAL DEPT				<u>679.00</u>
	TOTAL FUND				<u>679.00</u>
RMPCO	Courthouse Records Management Fees	45	200.00		<u>200.00</u>
	TOTAL DEPT				<u>200.00</u>
	TOTAL FUND				<u>200.00</u>
JUDED	Judicial Education Fees (State)	56	14.00		<u>14.00</u>
	TOTAL DEPT				<u>14.00</u>
	TOTAL FUND				<u>14.00</u>
CVC	Compensation To Victims of Crime	59	420.00		<u>420.00</u>
	TOTAL DEPT				<u>420.00</u>
	TOTAL FUND				<u>420.00</u>
STARR	State Arrest Fees	61	55.00		<u>55.00</u>
	TOTAL DEPT				<u>55.00</u>
	TOTAL FUND				<u>55.00</u>
BAT	Breath Alcohol Test Fees	65	30.00		<u>30.00</u>
	TOTAL DEPT				<u>30.00</u>
	TOTAL FUND				<u>30.00</u>

FEE CODE	FEE DESCRIPTION	GL ACCOUNT	COLLECTED	REFUNDS	LIABILITY
PAYPL	Partial Payment Plan	68	100.00		<u>100.00</u>
	TOTAL DEPT				100.00
	TOTAL FUND				<u>100.00</u>
FA	Fugitive Apprehension - STATE	69	70.00		<u>70.00</u>
	TOTAL DEPT				70.00
	TOTAL FUND				<u>70.00</u>
CCC	Consolidated Court Cost - STATE	70	560.00		<u>560.00</u>
	TOTAL DEPT				560.00
	TOTAL FUND				<u>560.00</u>
JCD	Juvenile Crime Delinquency (State)	71	3.00		<u>3.00</u>
	TOTAL DEPT				3.00
	TOTAL FUND				<u>3.00</u>
	<i>CLERK</i> UNKNOWN FEE CODE		6.00		6.00
TOTAL			25,953.57		25,953.57

## ALL RECORDS FROM 03/24/2000 TO 03/24/2000 DATE-TO-BE-PAID

VENDOR NAME	ACCOUNT #	ACCOUNT NAME	ITEM/REASON	INVOICE #	VP DATE	DATE TBP	PO NO	AMOUNT
AMBER NICOLE MARSHALL	2000 010-415-061	PETIT JURORS	JURY DUTY/MARCH 15	197538	03/23/2000	03/24/2000		6.00
ANDREW NATHANIEL GREEN	2000 010-415-061	PETIT JURORS	JURY DUTY/MARCH 15	197509	03/23/2000	03/24/2000		6.00
ANGELO THOMAS SAN	2000 010-415-061	PETIT JURORS	JURY DUTY/MARCH 15	197530	03/23/2000	03/24/2000		6.00
AUARY KNIGHT BONDROD	2000 010-415-061	PETIT JURORS	JURY DUTY/MARCH 15	197505	03/23/2000	03/24/2000		6.00
BETTY STEPHENS	2000 010-415-061	PETIT JURORS	JURY DUTY/MARCH 15	197501	03/23/2000	03/24/2000		20.00
BEVERLY STUART	2000 010-415-061	PETIT JURORS	JURY DUTY/MARCH 15	197518	03/23/2000	03/24/2000		6.00
BILLY WAYNE TOLAR	2000 010-415-061	PETIT JURORS	JURY DUTY/MARCH 15	197542	03/23/2000	03/24/2000		6.00
BOBBY GENE MARTIN	2000 010-415-061	PETIT JURORS	JURY DUTY/MARCH 15	197536	03/23/2000	03/24/2000		6.00
CARL RAY DELACERDA	2000 010-415-061	PETIT JURORS	JURY DUTY/MARCH 15	197503	03/23/2000	03/24/2000		20.00
CATHERINE POPE	2000 010-415-061	PETIT JURORS	JURY DUTY/MARCH 15	197539	03/23/2000	03/24/2000		6.00
CHARLOTTE HARRIS CHADIC	2000 010-415-061	PETIT JURORS	JURY DUTY/MARCH 15	197510	03/23/2000	03/24/2000		20.00
CHILD WELFARE BOARD	2000 010-415-061	PETIT JURORS	ROSSIE MAY KEEF	197535	03/23/2000	03/24/2000		6.00
CHILD WELFARE FUND	2000 010-415-061	PETIT JURORS	BENJAMIN PIERCE SIM	197512	03/23/2000	03/24/2000		20.00
CHILD WELFARE FUND	2000 010-415-061	PETIT JURORS	RICHARD EUGENE GARD	197514	03/23/2000	03/24/2000		6.00
CHILD WELFARE FUND	2000 010-415-061	PETIT JURORS	BETTY JANE FRYOR	197515	03/23/2000	03/24/2000		6.00
CHILD WELFARE FUND	2000 010-415-061	PETIT JURORS	BARBARA JEAN JORDAN	197516	03/23/2000	03/24/2000		6.00
CHILD WELFARE FUND	2000 010-415-061	PETIT JURORS	STEPHANIE DAVIS	197517	03/23/2000	03/24/2000		6.00
CHILD WELFARE FUND	2000 010-415-061	PETIT JURORS	DEBRA FINDLEY ADAMS	197519	03/23/2000	03/24/2000		6.00
CHILD WELFARE FUND	2000 010-415-061	PETIT JURORS	ALICE WILLIAMS LANG	197521	03/23/2000	03/24/2000		6.00
CHILD WELFARE FUND	2000 010-415-061	PETIT JURORS	MARC LYNN HOLCOMB	197527	03/23/2000	03/24/2000		6.00
CHILD WELFARE FUND	2000 010-415-061	PETIT JURORS	THELMA RIVERS	197537	03/23/2000	03/24/2000		6.00
CHILD WELFARE FUND	2000 010-415-061	PETIT JURORS	KAREN G FORTENBERRY	167544	03/23/2000	03/24/2000		6.00
CHILD WELFARE FUND	2000 010-415-061	PETIT JURORS	JAMES WINFRED YOUNG	197549	03/23/2000	03/24/2000		6.00
CHILD WELFARE FUND	2000 010-415-061	PETIT JURORS	AUDRE E. JOHNSON	197553	03/23/2000	03/24/2000		6.00
CINDY SELF	2000 010-426-024	TRAVEL & EDUCATIO	REGISTRATION & MILE 01		03/23/2000	03/24/2000		47.00
DALE JAMES SPENCER	2000 010-415-061	PETIT JURORS	JURY DUTY/MARCH 15	197551	03/23/2000	03/24/2000		6.00
DEBRA PAULINE LYNN	2000 010-415-061	PETIT JURORS	JURY DUTY/MARCH 15	197522	03/23/2000	03/24/2000		6.00
ELBERT SHEFFIELD	2000 010-426-045	U S MARSHALL TRAN	TRANSPORT INMATES	4932	03/23/2000	03/24/2000		17.45
EMMA ARZE PETERSON	2000 010-415-061	PETIT JURORS	JURY DUTY/MARCH 15	197533	03/23/2000	03/24/2000		6.00
ENTERGY	2000 010-442-038	UTILITIES-JUSTICE	1727262	9102688	03/23/2000	03/24/2000		16.36
EVIE JO EVANS	2000 010-415-061	PETIT JURORS	JURY DUTY/MARCH 15	197546	03/23/2000	03/24/2000		6.00
FRED MITCHELL PATTON	2000 010-415-061	PETIT JURORS	JURY DUTY/MARCH 15	097524	03/23/2000	03/24/2000		6.00
GARY ALAN RICHARD	2000 010-415-061	PETIT JURORS	JURY DUTY/MARCH 15	197524	03/23/2000	03/24/2000		6.00
HUGH BEVIL MEANS	2000 010-415-061	PETIT JURORS	JURY DUTY/MARCH 15	197532	03/23/2000	03/24/2000		6.00
JAMES DURWARD TILLERSON	2000 010-415-061	PETIT JURORS	JURY DUTY/MARCH 15	197545	03/23/2000	03/24/2000		6.00
JAMES MASTERS	2000 010-415-061	PETIT JURORS	JURY DUTY/MARCH 15	197541	03/23/2000	03/24/2000		6.00
JUNE MAXEY	2000 010-423-007	OFFICE SUPPLIES	32 HRS @ \$7.00/HR	6405	03/23/2000	03/24/2000		224.00
KIM STURROCK	2000 010-411-007	OFFICE SUPPLIES	7 HRS @ 6.50/HR.	2993	03/23/2000	03/24/2000		46.00
KIM STURROCK	2000 010-422-007	OFFICE SUPPLIES	6.5 HRS @ 6.00/HR.	6324	03/23/2000	03/24/2000		39.00
LANA SANFORD	2000 010-426-024	TRAVEL & EDUCATIO	REGISTRATION, MEAL, M	01	03/23/2000	03/24/2000		94.74
LARRY THOMS THOMPSON	2000 010-415-061	PETIT JURORS	JURY DUTY/MARCH 15	197547	03/23/2000	03/24/2000		6.00
MARGARET RAWLS	2000 010-415-061	PETIT JURORS	JURY DUTY/MARCH 15	197513	03/23/2000	03/24/2000		6.00
MARILYN ZWALLEN HORN	2000 010-415-061	PETIT JURORS	JURY DUTY/MARCH 15	197554	03/23/2000	03/24/2000		6.00
MAXIE RILEY	2000 010-401-021	DETCOG TRAVEL	MILEAGE & MEAL	6326	03/23/2000	03/24/2000		47.02
MELISSA KAY MEEKS	2000 010-415-061	PETIT JURORS	JURY DUTY/MARCH 15	197507	03/23/2000	03/24/2000		20.00
MELVIN DURWOOD LING	2000 010-415-061	PETIT JURORS	JURY DUTY/MARCH 15	197503	03/23/2000	03/24/2000		6.00
MODICA BROS.	2000 010-426-030	TIRES, TUBES	CORRECTION OF CK #5	6325	03/23/2000	03/24/2000		600.00
NETTIE MARIE FARTHING	2000 010-415-061	PETIT JURORS	JURY DUTY/MARCH 15	197511	03/23/2000	03/24/2000		6.00
RAY MACNEIL SELLS	2000 010-415-061	PETIT JURORS	JURY DUTY/MARCH 15	197548	03/23/2000	03/24/2000		6.00
ROBERT TERON LEE	2000 010-415-061	PETIT JURORS	JURY DUTY/MARCH 15	197534	03/23/2000	03/24/2000		6.00
SELENA DATES COLLINS	2000 010-415-061	PETIT JURORS	JURY DUTY/MARCH 15	197502	03/23/2000	03/24/2000		6.00
SHAUN MICHAEL HANCOCK	2000 010-415-061	PETIT JURORS	JURY DUTY/MARCH 15	197526	03/23/2000	03/24/2000		6.00
SHIRLEY ANN BROWN	2000 010-415-061	PETIT JURORS	JURY DUTY/MARCH 15	197508	03/23/2000	03/24/2000		20.00
STATE CVC FUND	2000 010-415-061	PETIT JURORS	BEVERLY JEAN THIBOD	197528	03/23/2000	03/24/2000		6.00
STATE CVC FUND	2000 010-415-061	PETIT JURORS	KAREN HELEN WALES	197529	03/23/2000	03/24/2000		6.00





ALL RECORDS FROM 03/24/2000 TO 03/24/2000 DATE-TO-BE-PAID

VENDOR NAME	ACCOUNT #	ACCOUNT NAME	ITEM/REASON	INVOICE #	VP DATE	DATE TBP	PO NO	AMOUNT
JAMES W. WATTS, P.E.	2000 053-451-016	PROFESSIONAL FEES	JANUARY 2000/1807	021000	03/23/2000	03/24/2000		367.55
MUSIC MOUNTAIN WATER CO	2000 053-437-007	CCP SUPPLIES & OP	51092000	001	03/23/2000	03/24/2000		52.75
U. S. POSTMASTER	2000 053-451-007	SUPPLIES & OPERAT	2 ROLLS STAMPS	5427	03/23/2000	03/24/2000		66.00
								486.30
TOTAL VOUCHERS								2,062.78

GENERAL FUND  
LIVE CHECKS

VENDOR NAME	ACCOUNT #	ACCOUNT NAME	ITEM/REASON	DATE	CHECK	AMOUNT
ENTERGY	2000 010-436-049	AID TO INDIGENTS	ANGELA DAVIS	AID03/22/2000	055786	35.00
CITY OF WOODVILLE	2000 010-436-049	AID TO INDIGENTS	ROSIA GRIFFIN	AID03/22/2000	055787	35.00
MAXIE RILEY	2000 010-401-099	CONTINGENCY FOR MISCELLANE	COURTHOUSE GRANT APPLICAPIC	03/22/2000	055788	142.54
CHESTER WATER SUPPLY COR.	2000 010-401-029	KIRBY MEMORIAL MUSEUM	ACCT # 141	KIR03/22/2000	055790	10.05
CITY OF WOODVILLE	2000 010-442-035	UTILITIES-COURTHOUSE	TAX OFFICE	03/22/2000	055791	153.70
CITY OF WOODVILLE	2000 010-442-038	UTILITIES-JUSTICE CENTER	JUSTICE CENTER	03/22/2000	055791	1,115.25
CITY OF WOODVILLE	2000 010-442-035	UTILITIES-COURTHOUSE	COURTHOUSE	03/22/2000	055791	106.14
COLMESNEIL VOL. FIRE DEPT	2000 010-401-026	RURAL FIRE PROTECTION	RURAL FIRE DISTRICT	03/22/2000	055792	75.00
UNITED STATES POSTAL SVC.	2000 010-401-008	POSTAGE FOR POSTAGE METER	POSTAGE FOR TAX OFFICE	03/22/2000	055793	1,500.00
ENTERGY	2000 010-436-049	AID TO INDIGENTS	JUANITA LACY	AID03/22/2000	055794	35.00
ENTERGY	2000 010-436-049	AID TO INDIGENTS	CLARISSA LUCE	AID03/22/2000	055795	20.72
ENTERGY	2000 010-436-049	AID TO INDIGENTS	BRIDGETTE MOYE	AID03/22/2000	055796	35.00
ENTERGY	2000 010-436-049	AID TO INDIGENTS	CHARLOTTE BERNARD	AID03/22/2000	055800	35.00
CITY OF WOODVILLE	2000 010-436-049	AID TO INDIGENTS	ANGELA PRIDE	AID03/22/2000	055801	35.00
CITY OF WOODVILLE	2000 010-436-049	AID TO INDIGENTS	NICOLE TAYLOR	AID03/22/2000	055802	35.00
THE PRINTERY	2000 010-440-007	SUPPLIES	ANNUAL REPORTS FOR AUDIT	03/22/2000	056044	123.60
CITY OF WOODVILLE	2000 010-436-049	AID TO INDIGENTS	STEPHANIE RILEY	AID03/22/2000	056045	35.00
SAM HOUSTON ELECTRIC CO	2000 010-436-049	AID TO INDIGENTS	BEATRICE LEWIS	AID03/22/2000	056046	35.00
UNITED STATES POSTAL SVC.	2000 010-401-008	POSTAGE FOR POSTAGE METER	POSTAGE FOR POSTAGE METR#1703	03/22/2000	056047	2,500.00
ENTERGY	2000 010-436-049	AID TO INDIGENTS	SHIRLEY TELFORD	AID03/22/2000	056048	35.00
TECON WATER COMPANIES, INC	2000 010-436-049	AID TO INDIGENTS	JUDY ENES	AID03/31/2000	056049	24.00
SAM HOUSTON ELECTRIC CO	2000 010-436-049	AID TO INDIGENTS	CLINT L. PHILLIPS	AID03/31/2000	056103	35.00
ENTERGY	2000 010-436-049	AID TO INDIGENTS	ROBERT DANNER	AID03/31/2000	056104	35.00
LOIS GILBERT	2000 010-401-050	ELECTION EXPENSE	80 HRS. @ 5.15/HR.	2/203/31/2000	056105	412.00
TOTAL CHECKS WRITTEN						6,605.00
TOTAL VOID CHECKS						0.00
TOTAL CHECK AMOUNT						6,605.00

GENERAL ROAD & BRIDGE  
LIVE CHECKS

VENDOR NAME	ACCOUNT #	ACCOUNT NAME	ITEM/REASON	DATE	CHECK	AMOUNT
TYLER CO PCT I	2000 020-496-021	TRANSFERS/R&B I=====	243 TRANSFER/GENERAL R&B	FEB03/03/2000	055782	69,883.22
TYLER CO PCT II	2000 020-496-022	TRANS/R&B II=====	206 TRANSFER/GENERAL R&B	FEB03/03/2000	055783	59,239.84
TYLER CO PCT IV	2000 020-496-024	TRANS/R&B IV=====	261 TRANSFER/GENERAL R&B	FEB03/03/2000	055784	74,990.47
TYLER CO PCT III	2000 020-496-023	TRANS/R&B III=====	288 TRANSFER/GENERAL R&B	FEB03/03/2000	055785	82,762.22
TOTAL CHECKS WRITTEN						286,875.75
TOTAL VOID CHECKS						0.00
TOTAL CHECK AMOUNT						286,875.75



ROAD & BRIDGE I  
LIVE CHECKS

VENDOR NAME	ACCOUNT #	ACCOUNT NAME	ITEM/REASON	DATE	CHECK	AMOUNT
MAXIE RILEY	2000 021-451-001	SALARY/TRUCK ALLOWANCE	TRUCK ALLOWANCE FOR APR R&B03/31/2000	056109		600.00
				TOTAL CHECKS WRITTEN		600.00
				TOTAL VOID CHECKS		0.00
				TOTAL CHECK AMOUNT		600.00

ROAD & BRIDGE II  
LIVE CHECKS

VENDOR NAME	ACCOUNT #	ACCOUNT NAME	ITEM/REASON	DATE	CHECK	AMOUNT
TYLER CO PCT III	2000 022-395-020	TRANSFER FROM GENERAL R&B	TYLER COUNTY PCT 3	COR03/10/2000	055789	23,555.38
CHESTER WATER SUPPLY COR.	2000 022-451-035	UTILITIES	ACCT #031	PCT03/22/2000	055790	10.05
JOSHUA MARSHALL	2000 022-448-001	SALARIES	CONTRACT LABOR PCT II	03/22/2000	055797	412.00
JAMES "RUSTY" HUGHES	2000 022-451-001	SALARY/TRUCK ALLOWANCE	TRUCK ALLOWANCE FOR APR	R&B03/31/2000	056108	600.00
TOTAL CHECKS WRITTEN						24,577.43
TOTAL VOID CHECKS						0.00
TOTAL CHECK AMOUNT						24,577.43

ROAD & BRIDGE III  
LIVE CHECKS

VENDOR NAME	ACCOUNT #	ACCOUNT NAME	ITEM/REASON	DATE	CHECK	AMOUNT
JOE MARSHALL	2000 023-451-001	SALARY/TRUCK ALLOWANCE	TRUCK ALLOWANCE FOR APR R&B03/31/2000	056107		600.00
				TOTAL CHECKS WRITTEN		600.00
				TOTAL VOID CHECKS		0.00
				TOTAL CHECK AMOUNT		600.00

ROAD & BRIDGE IV  
LIVE CHECKS

VENDOR NAME	ACCOUNT #	ACCOUNT NAME	ITEM/REASON	DATE	CHECK	AMOUNT
HENRY SAWYER	2000 024-451-001	SALARY/TRUCK ALLOWANCE	TRUCK ALLOWANCE FOR APR R&B03/31/2000	056106		600.00
				TOTAL CHECKS WRITTEN		600.00
				TOTAL VOID CHECKS		0.00
				TOTAL CHECK AMOUNT		600.00

TYLER CO AIRPORT/FAIRGROUNDS  
LIVE CHECKS

VENDOR NAME	ACCOUNT #	ACCOUNT NAME	ITEM/REASON	DATE	CHECK	AMOUNT
CITY OF WOODVILLE	2000 025-448-035	UTILITIES	RODED ARENA	03/22/2000	055791	301.52
						-----
TOTAL CHECKS WRITTEN						301.52
TOTAL VOID CHECKS						0.00
						-----
TOTAL CHECK AMOUNT						301.52

JAIL INTEREST & SINKING  
LIVE CHECKS

VENDOR NAME	ACCOUNT #	ACCOUNT NAME	ITEM/REASON	DATE	CHECK	AMOUNT
FNB-WOODVILLE BRANCH	2000 043-454-046	BOND PAYABLE, SERIES 1986	PRINCIPLE/CERT OF OBLIG	JAI03/31/2000	000002	225,000.00
FNB-WOODVILLE BRANCH	2000 043-454-047	INTEREST PAYABLE, SERIES 1	INTEREST/CERT OF OBLIG	JAI03/31/2000	000002	9,000.00
				TOTAL CHECKS WRITTEN		234,000.00
				TOTAL VOID CHECKS		0.00
				TOTAL CHECK AMOUNT		234,000.00

JUVENILE PROBATION  
LIVE CHECKS

VENDOR NAME	ACCOUNT #	ACCOUNT NAME	ITEM/REASON	DATE	CHECK	AMOUNT
TONYA SHEFFIELD	2000 054-451-012	PER DIEM	PER DIEM	03/22/2000	055798	150.00
TERRY ALLEN	2000 054-451-012	PER DIEM	PER DIEM	03/22/2000	055799	150.00
TOTAL CHECKS WRITTEN						300.00
TOTAL VOID CHECKS						0.00
TOTAL CHECK AMOUNT						300.00

TOTAL ALL CHECKS  
LIVE CHECKS

VENDOR NAME	ACCOUNT #	ACCOUNT NAME	ITEM/REASON	DATE	CHECK	AMOUNT
			TOTAL CHECKS WRITTEN			554,459.70
			TOTAL CHECKS VOIDED			0.00
			GRAND TOTAL AMOUNT			<u>554,459.70</u>







DATE 04/07/2000

JUVENILE PROBATION

V/P CLAIMS LIST

VCH101 PAGE 3

ALL RECORDS FROM 04/07/2000 TO 04/07/2000 V/P DATE

VENDOR NAME	ACCOUNT #	ACCOUNT NAME	ITEM/REASON	INVOICE #	VP DATE	DATE TBP	PO NO	AMOUNT
BOBBY BRUMFIELD	2000 054-451-046	RESTITUTION	RESTITUTION	6287	04/07/2000	04/07/2000		91.00
TONYA SHEFFIELD	2000 054-451-012	PER DIEM	OUT OF CO TRAINING	6288	04/07/2000	04/07/2000		40.01
								<hr/>
								131.01
			TOTAL VOUCHERS					1,320.52

ALL RECORDS FROM 04/10/2000 TO 04/10/2000 DATE-TO-BE-PAID

VENDOR NAME	ACCOUNT #	ACCOUNT NAME	ITEM/REASON	INVOICE #	VP DATE	DATE TBP	PO NO	AMOUNT
SOUTHWESTERN BELL TELE	2000 010-421-009	TELEPHONE	40928336524515	010	04/07/2000	04/10/2000		41.24
SOUTHWESTERN BELL TELE	2000 010-422-009	TELEPHONE	40928336524515	01R	04/07/2000	04/10/2000		19.04
SOUTHWESTERN BELL TELE	2000 010-414-009	TELEPHONE	40928336524515	01S	04/07/2000	04/10/2000		19.04
SOUTHWESTERN BELL TELE	2000 010-423-009	TELEPHONE	40928336524515	01T	04/07/2000	04/10/2000		19.04
SOUTHWESTERN BELL TELE	2000 010-440-019	OFFICE EQUIPMENT	40928336524515	01U	04/07/2000	04/10/2000		76.16
SOUTHWESTERN BELL TELE	2000 010-442-012	ELEVATOR REPAIRS	40928336524515	01W	04/07/2000	04/10/2000		19.04
SPURGER VOL. FIRE DEPT.	2000 010-401-026	RURAL FIRE PROTEC	RURAL FIRE PROTECTI	04072000	04/07/2000	04/10/2000		75.00
TROY SOILEU	2000 010-408-055	COURT APPOINTED A	DEMETRIUS MCQUEEN/#	01	04/07/2000	04/10/2000		550.00
TROY SOILEU	2000 010-408-055	COURT APPOINTED A	DEMETRIUS MCQUEEN/#	02	04/07/2000	04/10/2000		450.00
TYLER CO RURAL FIRE PCT	2000 010-401-026	RURAL FIRE PROTEC	RURAL FIRE PROTECTI	04072000	04/07/2000	04/10/2000		75.00
WARREN VOL. FIRE DEPT.	2000 010-401-026	RURAL FIRE PROTEC	RURAL FIRE PROTECTI	04072000	04/07/2000	04/10/2000		75.00
WHITE TAIL RIDGE FIRE D	2000 010-401-026	RURAL FIRE PROTEC	RURAL FIRE PROTECTI	04072000	04/07/2000	04/10/2000		75.00
WILDWOOD VOL. FIRE DEPT	2000 010-401-026	RURAL FIRE PROTEC	RURAL FIRE PROTECTI	04072000	04/07/2000	04/10/2000		75.00
WINTON WEBSTER	2000 010-408-055	COURT APPOINTED A	H. W. GAROUTTE/#907	01	04/07/2000	04/10/2000		250.00
WOODVILLE FORD, INC.	2000 010-401-046	SHERIFF'S CARS	2FAFF71WBXX149258	2361	04/07/2000	04/10/2000		20,008.75
WOODVILLE FORD, INC.	2000 010-401-046	SHERIFF'S CARS	2FAFF71WXYX149259	2364	04/07/2000	04/10/2000		20,008.75
WOODVILLE VOL. FIRE DEP	2000 010-401-026	RURAL FIRE PROTEC	RURAL FIRE PROTECTI	04072000	04/07/2000	04/10/2000		75.00
								48,620.85





DATE 04/07/2000

ROAD & BRIDGE III

V/P CLAIMS LIST

VCH101 PAGE 5

ALL RECORDS FROM 04/10/2000 TO 04/10/2000 DATE-TO-BE-PAID

VENDOR NAME	ACCOUNT #	ACCOUNT NAME	ITEM/REASON	INVOICE #	V/P DATE	DATE TRP	PO NO	AMOUNT
AT & T LONG DISTANCE	2000 023-451-035	UTILITIES	0206770048001	001T	04/07/2000	04/10/2000		5.45
GTE SOUTHWEST	2000 023-451-035	UTILITIES	415720378307934906	02	04/07/2000	04/10/2000		34.22
SOUTHWESTERN BELL TELE	2000 023-451-035	UTILITIES	40928336524515	01Z	04/07/2000	04/10/2000		14.87

54.54





DATE 04/07/2000

TYLER CO AIRPORT/FAIRGROUNDS

V/P CLAIMS LIST

VCH101 PAGE 7

ALL RECORDS FROM 04/10/2000 TO 04/10/2000 DATE-TD-BE-PAID

VENDOR NAME	ACCOUNT #	ACCOUNT NAME	ITEM/REASON	INVOICE #	V/P DATE	DATE TRP	PD NO	AMOUNT
CITY OF WOODVILLE	2000 025-448-035	UTILITIES	02030001/93565301	04072000	04/07/2000	04/10/2000		105.58
SAM HOUSTON ELECTRIC CO	2000 025-448-035	UTILITIES	3505-5/87000900	04072000	04/07/2000	04/10/2000		128.10
SAM HOUSTON ELECTRIC CO	2000 025-448-035	UTILITIES	3598-8/15981969	04072000A	04/07/2000	04/10/2000		99.23
SAM HOUSTON ELECTRIC CO	2000 025-448-035	UTILITIES	14006-1/79462640	04072000B	04/07/2000	04/10/2000		14.66
SAM HOUSTON ELECTRIC CO	2000 025-448-035	UTILITIES	131357-6/63976860	04072000C	04/07/2000	04/10/2000		15.53
SAM HOUSTON ELECTRIC CO	2000 025-448-035	UTILITIES	34268-3/63976831	04072000E	04/07/2000	04/10/2000		28.58
SOUTHWESTERN BELL TELE	2000 025-448-035	UTILITIES	40923838842224	01B	04/07/2000	04/10/2000		57.30
SOUTHWESTERN BELL TELE	2000 025-448-035	UTILITIES	409238388424515	01V	04/07/2000	04/10/2000		19.04

468.02

DATE 04/07/2000

LIBRARY FUND

B

V/P CLAIMS LIST

VCH101 PAGE

8

ALL RECORDS FROM 04/10/2000 TO 04/10/2000 DATE-TO-BE-PAID

VENDOR NAME	ACCOUNT #	ACCOUNT NAME	ITEM/REASON	INVOICE #	VP DATE	DATE TRF	PO NO	AMOUNT
SOUTHWESTERN BELL TELE	2000 036-492-050	LIBRARY BOOKS & S	40928336524515	001B	04/07/2000	04/10/2000		19.04

19.04

DATE 04/07/2000

T C COLLECTION CENTER

B

V/P CLAIMS LIST

VCH101 PAGE

9

ALL RECORDS FROM 04/10/2000 TO 04/10/2000 DATE-TO-BE-PAID

VENDOR NAME	ACCOUNT #	ACCOUNT NAME	ITEM/REASON	INVOICE #	VP DATE	DATE TRF	PO NO	AMOUNT
CYPRESS CREEK WATER	2000 037-451-035	UTILITIES		001	04/07/2000	04/10/2000		20.64
SOUTHWESTERN BELL TELE	2000 037-451-035	UTILITIES	40928836524515	0122	04/07/2000	04/10/2000		19.04

39.68

ALL RECORDS FROM 04/10/2000 TO 04/10/2000 DATE-TD-BE-PAID

VENDOR NAME	ACCOUNT #	ACCOUNT NAME	ITEM/REASON	INVOICE #	VP DATE	DATE TBP	PO NO	AMOUNT
AT & T LONG DISTANCE	2000 053-451-009	UTILITIES	0206770048001	010	04/07/2000	04/10/2000		54.22
SOUTHWESTERN BELL TELE	2000 053-451-009	UTILITIES	409283936524515	001A	04/07/2000	04/10/2000		112.23

166.45

ALL RECORDS FROM 04/10/2000 TO 04/10/2000 DATE-TO-BE-PAID

VENDOR NAME	ACCOUNT #	ACCOUNT NAME	ITEM/REASON	INVOICE #	VP DATE	DATE TRP	PG NO	AMOUNT
AT & T LONG DISTANCE	2000 054-437-009	ISP TELEPHONE	0206770048001	001V	04/07/2000	04/10/2000		34.06
SOUTHWESTERN BELL TELE	2000 054-437-009	ISP TELEPHONE	40928336524515	0123	04/07/2000	04/10/2000		17.82

51.88

TOTAL VOUCHERS

49,735.99

*Dance*

*returned to TX DOT  
2/11/00  
TH*

20-Tyler 229  
Dist. City/County  
Number

BRIDGE LOAD POSTING AGREEMENT

STATE OF TEXAS )  
COUNTY OF TRAVIS )

KNOW ALL MEN BY THESE PRESENTS

THIS AGREEMENT, made entered into and executed this 17 day of April, 2000, by and between the State of Texas acting by and through the Engineer - Director, with approval of the Texas Department of Transportation District, hereinafter called the "State," and Tyler County hereinafter called the "Local Jurisdiction"

WITNESSETH

WHEREAS, the State desires to enter into an agreement with the Local Jurisdiction concerning the installation of load posting signs on bridges within the Local Jurisdiction;

AGREEMENT

NOW, THEREFORE, the State and the Local Jurisdiction, in consideration of the mutual covenants and agreements herein contained, do mutually agree as follows:

The Local Jurisdiction agrees to order load posting signs from the State, the State agrees to administer Federal funds to provide the load posting signs at no cost to the Local Jurisdiction, and the Local Jurisdiction agrees to take delivery, install, and maintain the signs as stated in the sections to follow.

1. Signs. The Local Jurisdiction hereby orders the following quantities of signs:

- Sign R12-2Tb 31 ea.
- Sign R12-2Tc 4 ea.
- Sign R12-4Tb - ea.
- Sign W12-5 20 ea.

Weight limits for each proposed sign shall be as listed in Attachment A, "Sign Requirements," attached hereto and made part of this agreement.

2. Sign Supports and Hardware. In addition, the Local Jurisdiction hereby orders the Following quantities of sign supports with appropriate hardware, and the State hereby agrees to administer Federal funds to provide the sign supports and hardware at no cost to the Local Jurisdiction.

Posts 2 each

3. Authorization. The Local Jurisdiction shall properly authorize all proposed signs by ordinance, resolution, or other appropriate action and shall provide a copy of such which shall be attached hereto and designated Attachment B.
4. Delivery. The Local Jurisdiction shall take delivery of all proposed signs, sign supports, and hardware as agreed upon with the appropriate Texas Department of Transportation District Office.
5. Installation and Documentation. The Local Jurisdiction shall install all proposed signs in accordance with requirements of Attachment C, "Load Posting Signs," and Attachment D, "Vertical and Lateral Clearances". The Local Jurisdiction shall document the installation by marking the date sticker affixed to the back of each sign.
6. Notification and Inspection. The Local Jurisdiction shall notify the appropriate Texas Department of Transportation District Office in writing within 15 days after all Proposed signs have been properly installed. The Local Jurisdiction shall allow the Federal Highway Administration to perform on-site inspection of the installed signs and shall adjust any signs that are found to be improperly installed.
7. Maintenance. The Local Jurisdiction shall keep the installed signs clean, legible, and open to the view of approaching motorists for at least 150 feet. The Local Jurisdiction shall reinstall signs that have been knocked down by vandalism, traffic accidents, or other causes.
8. State Responsibility. The appropriate Texas Department of Transportation District Office agrees to provide the Local Jurisdiction with reasonable consultation assistance in accomplishing the objectives of this agreement.
9. State Indemnified. The Local Jurisdiction shall save harmless the State from all claims and liabilities due to activities of the Local Jurisdiction, its agents, officials, or employees performed under this agreement and which result from an error, omission, or negligent act of the Local Jurisdiction, its agents, officials, or employees. The Local Jurisdiction shall also save harmless the State from any and all expensed, including attorney fees which might be incurred by the State in litigation or otherwise resisting said claims or liabilities.

10. Disputes. Should disputes arise under this contract, the State's decision shall be final and binding.
11. Civil Rights Compliance. With regard to work performed under this contract, the Local Jurisdiction, in compliance with regulations of the Department of Transportation (49CFR21 and 23CFR710.405), Executive Orders 11246 and 11375 regarding Equal Employment Opportunity, and regulations of the Department of Labor (41 CFR60), shall not discriminate on the grounds of race, color, sex, or national origin.
12. Inspection of Books and Records. The Federal Highway Administration, the Department of Transportation, the Office of Inspector General, and the Comptroller General of the United States, or any duty authorized representatives thereof, shall have access to any books, documents, papers, and records which are directly pertinent to this contract for the purpose of making audits, examinations, excerpts, and transcriptions.

IN WITNESS WHEREOF, the State and Local Jurisdiction have executed duplicate counterparts of this Agreement.

THE LOCAL JURISDICTION

BY: Jerome Owens  
 Authorized Official

Jerome Owens  
 Name

County Judge  
 Title

Date April 17, 2000

THE STATE OF TEXAS

Certified as being executed for the purpose and effect of activating and/or carrying out the orders, established policies, or work programs heretofore approved and authorized by the Texas Department of Transportation  
 District:

By: \_\_\_\_\_  
 District Engineer                      District

Date \_\_\_\_\_



Tyler County, Texas OFF- System Bridge

ATTACHMENT A (SIGN REQUIREMENTS)

Lane Mark NO.	BRIDGE NUMBER	CURRENT POSTING				RECOMMENDED POSTING				SUPPLIES NEEDED										
		GROSS	AXLE	Tandem Axle	SIGN	GROSS	AXLE	Tandem Axle	SIGN	DECALS		SIGNS					Posts	Hardware	CLOSURE Barricades	
										Gross	Axle	R12-2Tb	R12-2Tc	W12-5	R12-3Tb	R12-4Tc				
1	2291AA01 31001	PCT 2			CLOSED		17,500		R12-2TB											
2	2291AA01 31001	PCT 2	5,000		R12-2TB		10,000		R12-2TB											
3	2291AA01 31001	PCT 2	7,500		R12-2TB	RECOMMEN			CLOSE	BRIDGE										
4	2291AA01 41002	PCT 2	17,500		R12-2TB		15,000		R12-2TB											
5	2291AA01 241001	PCT 2	15,000		R12-2TB		15,000		R12-2TB											
6	2291AA01 251001	PCT 2	7,500		R12-2TB	RECOMMEN			CLOSE	BRIDGE										
7	2291AA01 311001	PCT 1	7,500		R12-2TB			7,500	R12-2TB											
8	2291AA01 321001	PCT 2	17,500		R12-2TB		17,500		R12-2TB											
9	2291AA01 441001	PCT 2	17,500		R12-2TB		17,500		R12-2TB											
10	2291AA01 441002	PCT 2	17,500		R12-2TB		17,500		R12-2TB											
11	2291AA01 451001	PCT 2	17,500		R12-2TB	RECOMMEN			CLOSE	BRIDGE										
12	2291AA01 541001	PCT 3	10,000		R12-2TB	RECOMMEN			CLOSE	BRIDGE										
13	2291AA01 581001	PCT 2	7,500		R12-2TB	RECOMMEN			CLOSE	BRIDGE										
14	2291AA01 791002	PCT 4			NONE			21,000	R12-2TC											
15	2291AA02 301001	PCT 3	10,000		R12-2TB			10,000	R12-2TB											
16	2291AA02 591001	PCT 4			NONE			17,500	R12-2TB											
17	2291AA02 771001	PCT 4			NONE			7,500	R12-2TB											
18	2291AA02 541001	PCT 4	17,500		R12-2TB			17,500	R12-2TB											
19	2291AA02 581001	PCT 4	17,500		R12-2TB			12,500	R12-2TB											
20	2291AA02 321001	PCT 4			NONE			7,500	R12-2TB											
21	2291AA03 151001	PCT 1			NONE	RECOMMEN			CLOSE	BRIDGE										
22	2291AA03 351002	PCT 1	15,000		R12-2TB			15,000	R12-2TB											
23	2291AA03 551001	PCT 1	10,000		R12-2TB			10,000	R12-2TB											
24	2291AA03 311001	PCT 4	17,500		R12-2TB			17,500	R12-2TB											
25	2291AA03 381001	PCT 2	17,500		R12-2TB			17,500	R12-2TB											
26	2291AA04 71001	PCT 3	5,000		R12-2TB	RECOMMEN			CLOSE	BRIDGE										
27	2291AA04 431001	PCT 1	17,500		R12-2TB			17,500	R12-2TB											
28	2291AA03 381002	PCT 2	17,500		R12-2TB			17,500	R12-2TB											
29	2291AA01 561003	PCT 3			NONE			15,000	R12-2TB											
30	2291AA01 461001	PCT 3	5,000		R12-2TB			17,500	R12-2TB											
31	2291AA02 181001	PCT 4			NONE			21,000	R12-2TC											
32																				
33																				
34																				
35																				
36																				
37																				
38																				
39																				
40																				
41																				
42																				
43																				
44																				
45																				
46																				
47																				
48																				
49																				
50																				
51																				
52																				
53																				
54																				
55																				
56																				
57																				
58																				
59																				
60																				

Tyler County, Texas OFF- System Bridge

ATTACHMENT A (SIGN REQUIREMENTS)

Lone Star	BRIDGE	CURRENT POSTING	RECOMMENDED POSTING	SUPPLIES NEEDED																
01																				
02																				
03																				
04																				
05																				
06																				
				SUPPLY TOTALS																

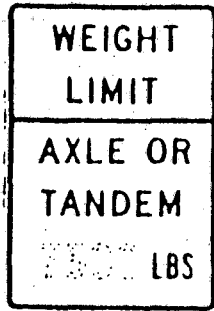

R12-2Tb  
24" x 36"

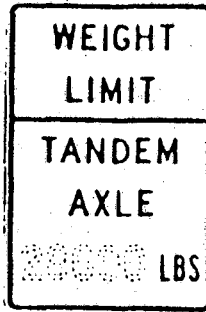

R12-2Tc  
24" x 36"

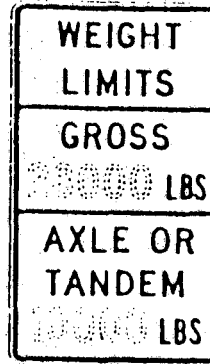

R12-4Tb  
24" x 42"

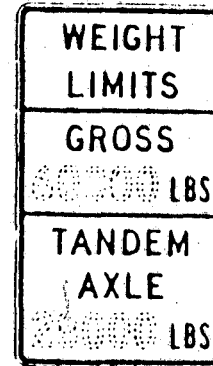

R12-4Tc  
24" x 42"

### WEIGHT LIMIT SIGNS

A Weight Limit sign shall be located just ahead of the bridge in each direction of travel. Six feet from the abutment is a good location if the bridge is on an unpaved or low-speed road. This distance should be increased if the bridge is on a high-speed road.



W12-3  
36" x 36"

### ADVANCE WARNING SIGN

The Load Zone Bridge sign should be used to warn of a bridge with a posted weight restriction. The sign should be placed so as to allow the driver of an overweight vehicle to detour around the bridge. It is also recommended that a WEIGHT LIMIT sign be placed beside or 100 feet behind each advance warning sign.

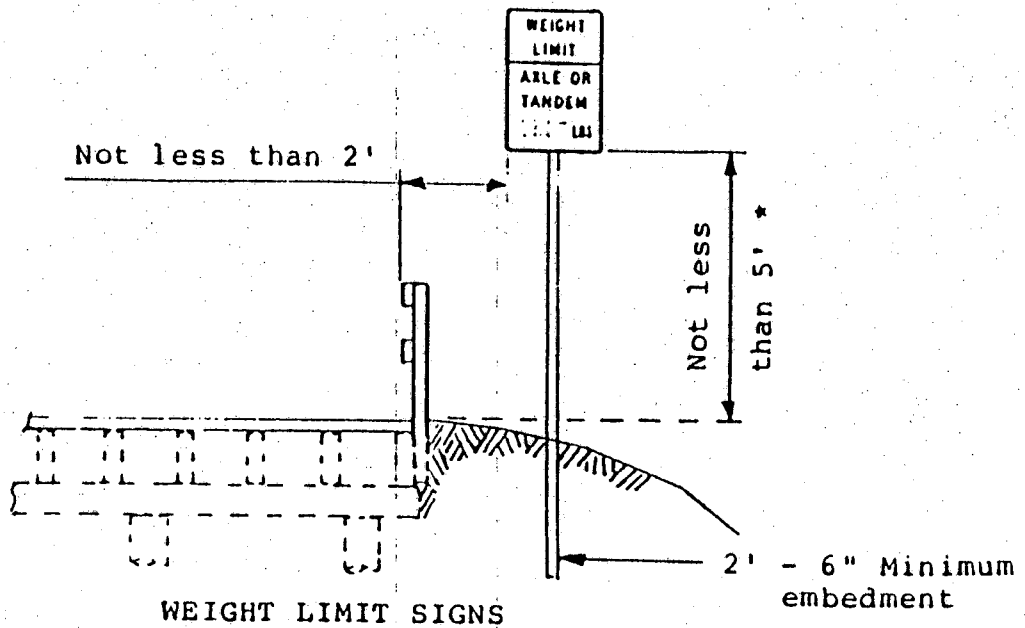

Edge of the traveled surface (including paved shoulder if present)

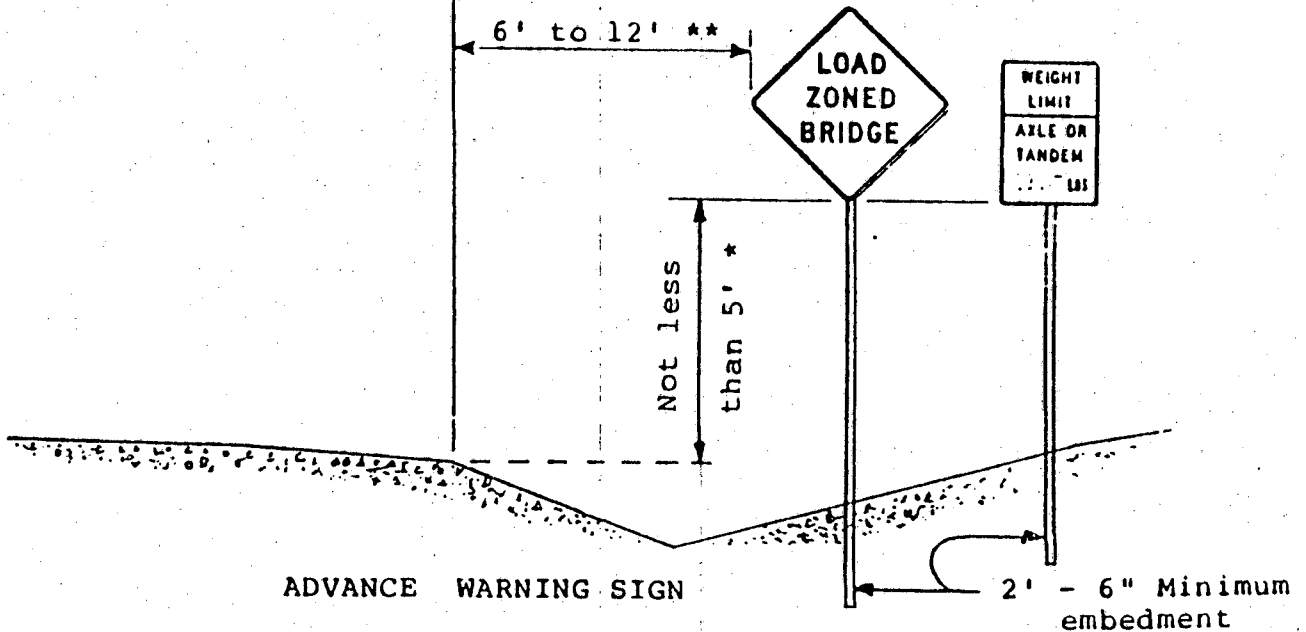

\* This dimension should be a minimum of 7' in business or residential areas where parked vehicles may block the sign.

\*\* This dimension may be reduced to a minimum of 2' in business or residential areas.

DEED OF EASEMENT

STATE OF TEXAS X  
COUNTY OF TYLER X

Know all men by these presents, that **WE, THE COUNTY OF TYLER**, for and in consideration of the sum TEN DOLLARS AND NO/100---(\$10.00) and other valuable consideration, to the **COUNTY OF TYLER** in hand paid by **THOMAS FENLON TAYLOR**, the receipt of which is hereby acknowledged and confessed, have granted, bargained and sold, and by these presents do grant, bargain, sell and convey unto the said **THOMAS FENLON TAYLOR**, his heirs and assigns, the free and uninterrupted use, liberty and privilege of and passage in and along a certain way across a certain tract of land situated in said county and being in the **JAMES BUNT SURVEY, ABSTRACT NO. 7**, Tyler County, Texas, said easement is a **THIRTY FOOT (30')** road easement being more particularly described by metes and bounds as set out in Exhibit "A" and attached hereto.

Together with free ingress, egress, regress to and for the said **THOMAS FENLON TAYLOR**, his heirs and assigns, and he and their tenants, with wagons, carriages and other vehicles, horses, mules or cattle, as by him or their shall be necessary or convenient, at all times and seasons forever, in, along, upon and out of said way, in common with him, the said **THOMAS FENLON TAYLOR**, his heirs and assigns, and him and their tenants; to have and to hold all and singular the privileges aforesaid to him the said **THOMAS FENLON TAYLOR**, his heirs and assigns to their proper use and behoof, in common with them, the said **THOMAS FENLON TAYLOR**, his heirs and assigns.

WITNESS MY HAND this 12<sup>th</sup> day of JUNE, 2000.

  
CD WOODROME  
Tyler County Commissioner Precinct 1

  
RUSTY HUGHES  
Tyler County Commissioner Precinct 2

  
JOE MARSHALL  
Tyler County Commissioner Precinct 3

  
HENRY SAWYER  
Tyler County Commissioner Precinct 4

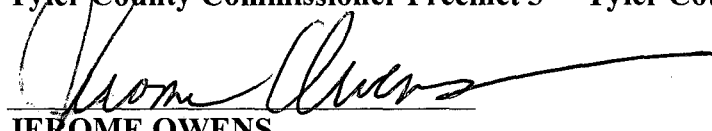
  
JEROME OWENS  
County Judge

STATE OF TEXAS X

COUNTY OF TYLER X

GIVEN UNDER MY HAND AND SEAL OF OFFICE, this the 12<sup>th</sup> day of JUNE, 2000 by JUDGE JEROME OWENS.

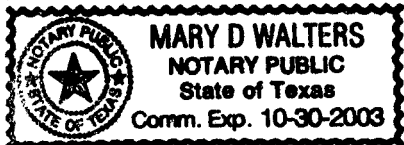

Mary D. Walters  
NOTARY PUBLIC, STATE OF TEXAS

STATE OF TEXAS X

COUNTY OF TYLER X

GIVEN UNDER MY HAND AND SEAL OF OFFICE, this the 12<sup>th</sup> day of JUNE, 2000, by CD WOODROME.

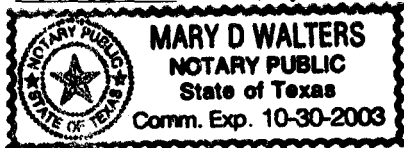

Mary D. Walters  
NOTARY PUBLIC, STATE OF TEXAS

STATE OF TEXAS X

COUNTY OF TYLER X

GIVEN UNDER MY HAND AND SEAL OF OFFICE, this the 12<sup>th</sup> day of JUNE, 2000, by JUDITH HUGHES.

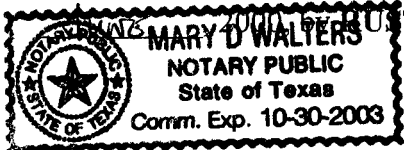

Mary D. Walters  
NOTARY PUBLIC, STATE OF TEXAS

STATE OF TEXAS X

COUNTY OF TYLER X

GIVEN UNDER MY HAND AND SEAL OF OFFICE, this the 12<sup>th</sup> day of JUNE, 2000, by MARY D WALTERS MARSHALL.

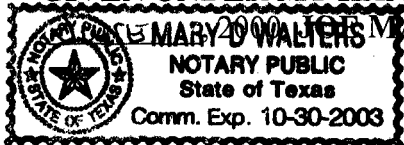

Mary D. Walters  
NOTARY PUBLIC, STATE OF TEXAS

STATE OF TEXAS X

COUNTY OF TYLER X

GIVEN UNDER MY HAND AND SEAL OF OFFICE, this the 12<sup>th</sup> day of JUNE, 2000, HENRY SAWYER.

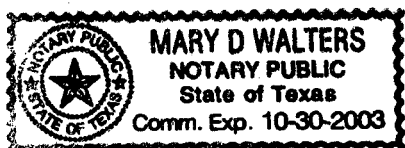

Mary D. Walters  
NOTARY PUBLIC, STATE OF TEXAS

AFTER RECORDING RETURN TO:

Grantee,  
Tom Taylor  
2301 Branard  
Houston, TX 77098

PREPARED IN LAW OFFICES OF:

J. MICHAEL RISINGER  
314 S. Magnolia  
Woodville, TX 75979

## FIELDNOTE DESCRIPTION

FIELDNOTES TO A 0.089 ACRE TRACT OF LAND AS SITUATED IN THE JAMES BLUNT SURVEY, A-7, TYLER COUNTY, TEXAS AND BEING A 30 FT. WIDE ROAD EASEMENT FOR INGRESS-EGRESS AND BEING OVER AND ACROSS A PART OF THE RESIDUE OF THE COUNTY OF TYLER CALLED 178.47 ACRE TRACT AS DESCRIBED IN VOLUME 179, PAGE 541 OF THE DEED RECORDS OF TYLER COUNTY. SAID 0.089 ACRE TRACT BEING MORE PARTICULARLY DESCRIBED BY METES AND BOUNDS AS FOLLOWS:

BEGINNING AT A 2" IRON PIPE FOUND FOR AN INTERIOR ANGLE CORNER ON THE EASTERLY BOUNDARY OF SAID 178.47 ACRES AT A SOUTH CORNER OF THE RESIDUE OF THE LOUISIANA-PACIFIC 777 1/2 ACRE TRACT, SAME BEING THE SOUTHWEST CORNER OF THE THOMAS FENLON TAYLOR 105.089 ACRE TRACT RECORDED IN VOLUME 532, PAGE 782 OF THE OFFICIAL PUBLIC RECORDS OF TYLER COUNTY AND SAID IRON PIPE BEING THE NORTHWEST CORNER OF THIS TRACT AND EASEMENT;

THENCE S 89°58'49"E 32.68 FT., WITH A NORTH LINE OF THE COUNTY 178.47 ACRES AND THE SOUTH LINE OF SAID THOMAS 105.089 ACRES, TO A 1/2" IRON ROD SET FOR THE NORTHEAST CORNER OF THIS TRACT AND EASEMENT;

THENCE S 23°23'W 156.96 FT. TO A 1/2" IRON ROD SET IN THE CENTER OF COUNTY ROAD NO. 2015 FOR THE SOUTHEAST CORNER OF THIS TRACT AND EASEMENT, FROM SAID CORNER A 1/2" IRON ROD SET FOR REFERENCE CORNER BEARS. N 23°23'E 25.55 FT.;

THENCE N 12°34'W 51.10 FT., WITH THE CENTER OF SAID COUNTY ROAD, TO A 1/2" IRON ROD SET FOR THE SOUTHWEST OF THIS TRACT AND EASEMENT, FROM WHICH A 1/2" IRON ROD SET FOR A REFERENCE CORNER BEARS N 23°23'E 25.55 FT.;

THENCE N 23°23'E 102.63 FT., TO THE PLACE OF BEGINNING AND CONTAINING WITHIN THESE BOUNDS 0.089 OF AN ACRE OF LAND.

SURVEYED MARCH 17, 2000

I, LYLE RAINEY, REGISTERED PROFESSIONAL LAND SURVEYOR NO. 4800, DO HEREBY CERTIFY THAT THE FIELDNOTE DESCRIPTION OF THE ABOVE DESCRIBED TRACT WAS PREPARED FROM AN ACTUAL AND ACCURATE ON THE GROUND SURVEY AND THAT SAME IS TRUE AND CORRECT.

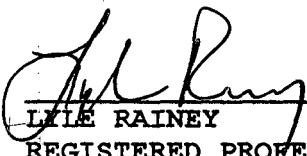
  
 LYLE RAINEY  
 REGISTERED PROFESSIONAL  
 LAND SURVEYOR NO. 4800



Louisiana-Pacific Corp.  
Residue of 777 1/2 Acres

AREA SURVEYING & MAPPING  
1116 S. MAGNOLIA  
WOODVILLE, TEXAS 75979  
(409) 283-8197 OFFICE

Thomas Fenlon Taylor  
105.089 Acre Tract  
Vol. 532, Pg. 782

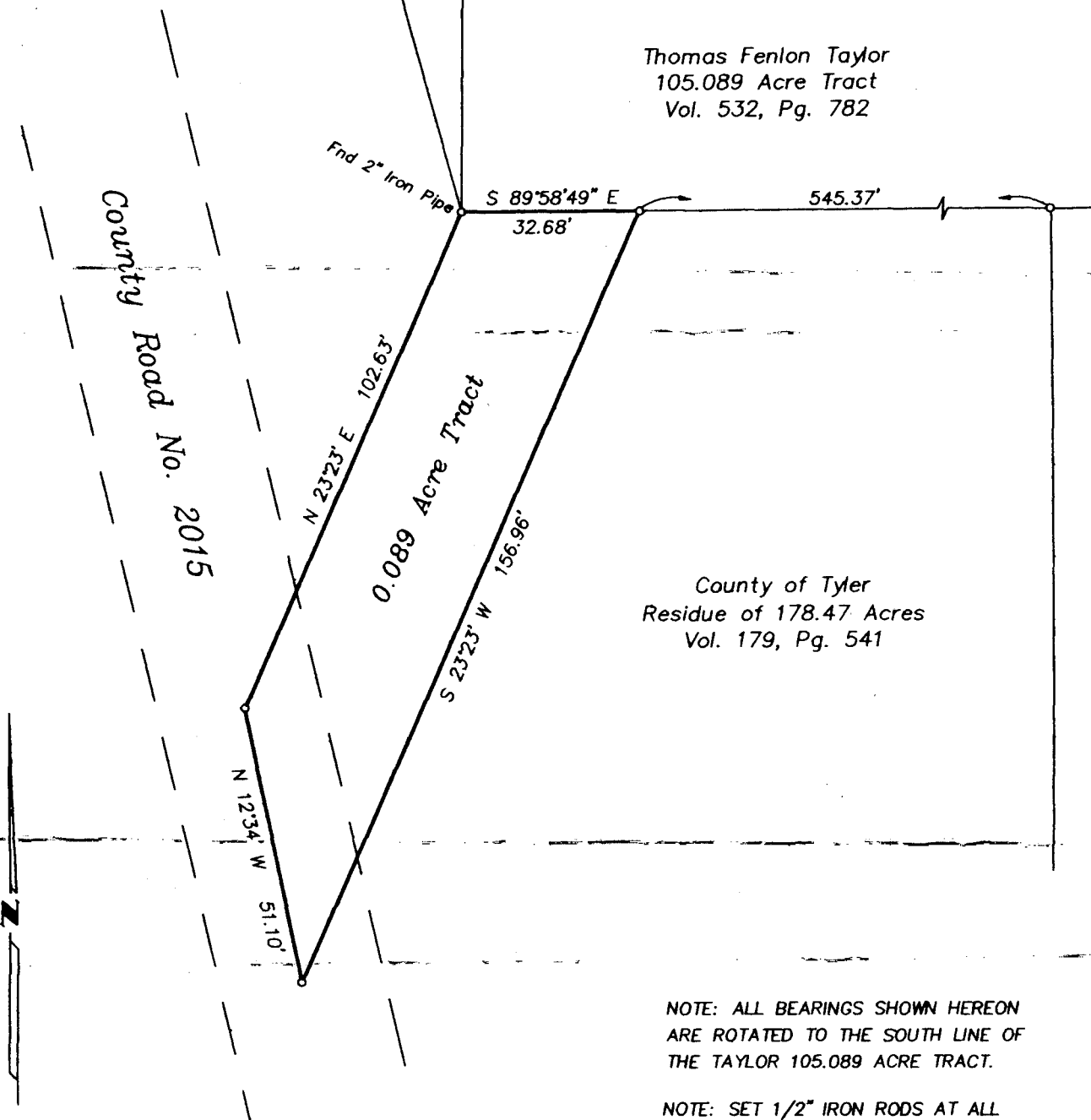

County of Tyler  
Residue of 178.47 Acres  
Vol. 179, Pg. 541

NOTE: ALL BEARINGS SHOWN HEREON  
ARE ROTATED TO THE SOUTH LINE OF  
THE TAYLOR 105.089 ACRE TRACT.

NOTE: SET 1/2" IRON RODS AT ALL  
CORNERS UNLESS OTHERWISE NOTED.

SCALE 1" = 30'

SURVEY PLAT SHOWING

A 0.089 ACRE TRACT AS SITUATED IN THE JAMES BLUNT SURVEY, A-7, TYLER COUNTY, TEXAS, AND BEING A 30 FT. WIDE EASEMENT FOR INGRESS-EGRESS OVER AND ACROSS A PART OF THE RESIDUE OF THAT SAME 178.47 ACRE TRACT CONVEYED TO THE COUNTY OF TYLER BY DEED RECORDED IN VOLUME 179, PAGE 541 OF THE DEED RECORDS OF TYLER COUNTY.

I, LYLE RAINEY, REGISTERED PROFESSIONAL LAND SURVEYOR NO. 4800, DO HEREBY CERTIFY THAT THIS SURVEY PLAT WAS PREPARED FROM AN ACTUAL AND ACCURATE ON THE GROUND SURVEY AND THAT SAME IS TRUE AND CORRECT.

SURVEYED MARCH 17, 2000

*[Signature]*  
LYLE RAINEY  
REGISTERED PROFESSIONAL  
LAND SURVEYOR NO. 4800





THE STATE OF TEXAS  
COUNTY OF TYLER

I hereby certify that the foregoing instrument with its certificate of authentication was filed for record in my office on the 13 day of June 2000 at 12:00 o'clock P M. and was this day duly recorded at 9:00 A.M., in Vol. 677 Pages 472 et seq. OFFICIAL PUBLIC RECORDS of said County.

13 Witness my hand and official seal at office in Woodville this day of June 2000.



Donnie Ferguson Clerk,  
County Court, Tyler County, Texas

By Debra Green Deputy

6/13/00  
00-2093

County of Tyler

to

Sharon Carlson Taylor

R ->

Comm. Court  
Apr 10, 2000

12:00 PM

FINANCIAL PLANNING  
FOR RETIREMENT

and the rest of your life

RICK KILEY  
Regional Manager

**COPELAND**

A member of citigroup

510 Bering Dr., Suite 230  
Houston, TX 77057  
Tel: (713) 977-7104  
Tel: (800) 247-4149  
Fax: (713) 977-7160  
EMail: rkiley@copeland.com  
Web Site: www.copeland.com

Copeland Associates, Inc.  
Copeland Equities, Inc.

# Tyler County

*April 2000*

---

---

citistreet  
**COPELAND**

A State Street and Citigroup Company

FINANCIAL PLANNING  
FOR RETIREMENT

and the rest of your life

STATE STREET. *and* citigroup 

**citistreet**

*The Copeland Companies*

*SSgA/ Retirement  
Investment Services*

*WELLSPRING Resources*

*Strategic Retirement/Benefits  
Specialist*

*with Corporate Affiliates*

**SSGA.**  
STATE STREET GLOBAL ADVISORS

**SALOMON SMITH BARNEY**  
A member of citigroup 

**Travelers Insurance**  
A member of citigroup 

**CITIBANK** 

FINANCIAL PLANNING  
FOR RETIREMENT

and the rest of your life

## The Copeland Team

Rick Kiley  
*Regional Manager*

Ted Lukeman  
*Account Executive*

# FINANCIAL PLANNING FOR RETIREMENT

and the rest of your life

Natio

## COPELAND

A member of citigroup

7(b) Deferred Compensat

de:



New York State  
Deferred Compensation Plan



- 35 Regional Offices
  - Houston Regional Office
  - Dallas Regional Office
- National Headquarters  
East Brunswick, NJ
- Independent TPA
- \$24 Billion Assets
- 1.2 Million Participants

FINANCIAL PLANNING  
FOR RETIREMENT

and the rest of your life

## Purpose

*To Provide a unique and exclusive package  
of services and insurance/investment options*

# FINANCIAL PLANNING FOR RETIREMENT

and the rest of your life

## Suggested Insurance & Investment Options

**Travelers Insurance**  
A member of citigroup



- Gold Track Select  
Variable Annuity

issued by The Travelers Insurance  
Company, One Tower Square,  
Hartford, CT 06183

**COPELAND**

A member of citigroup

- <sup>COPELAND</sup>  
*Mutual Fund*  
**Select** Portfolios
- The CHART Program®
- Co-Plan

FINANCIAL PLANNING  
FOR RETIREMENT

and the rest of your life

## Savings and Investment Options

- Number of Investment Options
  - Gold Track Select:
    - 40 Variable
    - 1 Fixed
  - MFSP:
    - 19 Mutual Funds
    - 1 Money Market



FINANCIAL PLANNING  
FOR RETIREMENT

and the rest of your life

## Savings and Investment Options

### *Gold Track Select Variable Annuity*

- Variable Annuity
  - Mortality and Expense Risk Charge: 0.90%
  - Administration Fee: 0%
  - 40 Fund Options
  - Fixed Account Option
    - » Current Crediting Rate: 5.35%
    - » Minimum Guaranteed Rate: 3%
  - Declining Surrender Charge (Based on Date of Certificate)
  - Benefit Sensitive Withdrawals
  - 100% Transferability Among Fund Options

# FINANCIAL PLANNING FOR RETIREMENT

and the rest of your life

## Withdrawal Provisions



- Surrender Charge on Distributions:

Certificate Year:	1	2	3	4	5	6+
Percent:	5%	4%	3%	2%	1%	0

- Surrender Charge is Waived for:

- Separation from Service
- Hardship Withdrawals
- Death
- Disability
- Minimum Distribution (age 70½ +)

# FINANCIAL PLANNING FOR RETIREMENT

and the rest of your life



- Fixed Interest Rates (as of 6/1/99)
  - Gold Track Select  
Fixed Rate Account: 5.35% current interest  
3% minimum  
guaranteed rate

# FINANCIAL PLANNING FOR RETIREMENT

and the rest of your life



## Class Categories of Variable Annuity Funds

### International Stock

American Odyssey  
International Fund  
Lazard International  
Stock Portfolio  
Smith Barney  
International Stock  
Portfolio

### Aggressive Growth

Alliance Growth Portfolio  
American Odyssey  
Emerging Opportunities  
Capital Appreciation  
Portfolio (Dreyfus)  
American Odyssey Global  
High Yield Bond Fund  
Travelers Disciplined Small  
Cap Stock Portfolio  
Warburg Pincus Emerging  
Markets Portfolio  
Delaware Small CAP Value  
Series  
Salomon Brothers Capital  
Fund

### Growth

American Odyssey Core  
Equity Fund  
Equity Income Portfolio  
Federated Stock Portfolio  
Large Cap Portfolio  
(Fidelity)  
MFS Total Return  
Portfolio  
Putnam Diversified  
Income Portfolio  
Smith Barney High  
Income Portfolio  
Smith Barney Income and  
Growth Portfolio  
Travelers Managed  
Assets Trust  
Travelers Social  
Awareness Stock  
Portfolio  
Utilities Portfolio (Smith  
Barney)

Delaware Investments  
REIT Series  
MFS Mid Cap Growth  
Portfolio  
MFS Research Portfolio  
Montgomery Growth  
Fund  
Op Capp Equity Portfolio  
Salomon Brothers  
Investors Fund  
Smith Barney Large Cap  
Growth Portfolio  
Strategic Stock Portfolio  
Strong Schafer Value  
Fund II  
Travelers Large Cap  
Portfolio  
Travelers Discipline Mid  
Cap Stock Portfolio  
Salomon Brothers Total  
Return Fund

### Conservative Return Options

American Odyssey  
Intermediate-Term Bond  
Fund  
American Odyssey Long-  
Term Bond Fund  
High Yield Bond Trust  
Smith Barney Money Market  
Portfolio  
Travelers U.S. Government  
Securities  
Travelers Fixed Guaranteed  
Account

*Gold Track Select Annuity is  
issued by The Travelers  
Insurance Company, One Tower  
Square, Hartford, CT 06183*

# FINANCIAL PLANNING FOR RETIREMENT

and the rest of your life

## COPELAND *Mutual Fund* Select Portfolios

- Open Mutual Fund Platform
- No-Load NAV Program

### Open Fund Selection

- *National Securities Clearing Corporation's "Fundserv" Program*
- *No-Load In No-Load Out*
- *Same Day*
- **MUTUAL FUND Selection Service**

FINANCIAL PLANNING  
FOR RETIREMENT

and the rest of your life

COPELAND  
*Mutual Fund*  
Select Portfolios

## *Fund Selection Process*

- Establish a Minimum Criteria
- Quantitative and Qualitative Analysis
- Large Universe of Mutual Funds
- Annual Review of Fund Selections

# FINANCIAL PLANNING FOR RETIREMENT

and the rest of your life

## Mutual Fund Platform

### *Investment Options*



LORD, ABBETT & CO.  
*Investment Management*

*A Tradition of Performance Through Disciplined Investing*

LOOMIS SAYLES FUNDS

*The Power of A Passion*



STRONG FUNDS



HOTCHKISS  
AND  
WILEY  
FUNDS



Janus Funds



AIM

Dreyfus



OppenheimerFunds<sup>SM</sup>



THE VANGUARD GROUP  
THE INVESTMENT MANAGEMENT COMPANY



Fidelity  
Investments<sup>®</sup>



Founders Funds

For more information, including fees, charges, and expenses and the risks associated with investing in a variable investment option, your Copeland Account Executive will give your employees each applicable prospectus, disclosure statement and investment advisory agreement. They should carefully read all investment information before deciding to direct investment.

*Variable annuities and mutual funds offered through Copeland Equities LLC a subsidiary of Copeland Associates LLC*

# FINANCIAL PLANNING FOR RETIREMENT

and the rest of your life

- AIM Blue Chip A
- AIM Global Growth & Income A
- AIM International Equity A
- American Century Income & Growth Advisor
- American Century International Growth Advisor
- Berger Small Cap Value Inv
- Dreyfus Appreciation
- Fidelity Advisor Growth Opp T
- Fidelity Adv Hi-Yield T
- Founders Balanced
- Franklin Small Cap Growth A
- Gabelli Value
- Invesco S&P 500 Index II
- Lexington GNMA Income
- Oppenheimer Quest Balanced Value A
- PIMCO Target A
- Smith Barney Concert Alc Social A
- Strong Corporate Bond
- Strong Government Securities
- Vanguard Money Market

- *No-Load In  
No-Load Out*
- *Same Day Pricing*
- *Asset Class  
Diversification*
- *Management Style  
Variety*
- *Investment  
Philosophy Mix*

For more information, including fees, charges, and expenses and the risks associated with investing in a variable investment option, your Copeland Account Executive will give your employees each applicable prospectus, disclosure statement and investment advisory agreement. They should carefully read all investment information before deciding to direct investment.

An investment in a money market fund is neither insured nor guaranteed by the U.S. government and there is no assurance that the fund will maintain a stable net asset value of \$1.00 per share.

*Variable annuities and mutual funds offered through Copeland Equities LLC, a subsidiary of Copeland Associates LLC*



FINANCIAL PLANNING  
FOR RETIREMENT

and the rest of your life

## Asset Classes/ Benchmarks

### *Asset Class*

International Equity - Foreign/World  
Long Term Bond - High Yield  
Domestic Equity - Small Cap  
Domestic Equity - Medium Cap  
Domestic Equity - Large Cap (Growth)  
Domestic Equity - Large Cap (Value)  
Life-style/Balanced  
Intermediate Term Bond

### *Benchmark*

MSCI EAFE Index  
Salomon High Yield Index  
Russell 2500  
Standard & Poor's 400  
Russell 1000 (Growth)  
Russell 1000 (Value)  
Rogers Casey US Balanced Per Group  
Lehman Brothers Intermediate  
Government /Corporate

FINANCIAL PLANNING  
FOR RETIREMENT

and the rest of your life

## Technological Information

- Web-Site Address
  - [www.copeland.com](http://www.copeland.com)
- 800 Number
  - HELPLINE Counselor Availability
  - 24 hour Voice Response Unit

FINANCIAL PLANNING  
FOR RETIREMENT

and the rest of your life

## Technological Information

- Internet Fees
  - There are no fees associated with Internet Access
- Capabilities
  - Account Balance
  - Transfers Capabilities
  - Current Investment Allocation
  - Fund Descriptions
  - Fund Performance
  - Answers to Frequently Asked Questions

FINANCIAL PLANNING  
FOR RETIREMENT

and the rest of your life

**Administration  
and Service**

- On-Site Account Executive
- Regional Office - Houston, TX

FINANCIAL PLANNING  
FOR RETIREMENT

and the rest of your life

## Retirement Plan Education Meetings

- Set schedule for informational meetings on “Plan Enhancements” and “Understanding your Investment Options”.
- Send letter to each employee inviting them to attend scheduled informational meetings.
- Schedule individual appointments with employees.

FINANCIAL PLANNING  
FOR RETIREMENT

and the rest of your life

**Personal Planning,  
Enrollment and Service**

Personal On-Site Counseling

The **Personal**  
*Retirement Plan*

- Suitability
- Retirement Needs
- Paycheck Analysis
- Plan Rules
- Follow-Up

Linked to Recordkeeping System

# FINANCIAL PLANNING FOR RETIREMENT

and the rest of your life

## Summary

- National Personal Retirement Planning Specialist  
*Single Source*  
Retirement Solutions
  - Employee Education and Communication
  - Personal Planning, Enrollment and Servicing
  - Technological Leadership
  - Excellent Fund Performance
  - Low Cost
  - Great Participation
- *Frequent  
Worksite  
Availability*
  - *Uniform  
Employee  
Counseling*

Entity Number - 43217  
 Name - CITY OF WOODVILLE

Prepared by: Ted Lukeman  
 (281) 379-3083  
 Data as of: 2/4/00

Total Eligible: 30  
 Total in Plan: 9  
 Participants  
 Actively Deferring: 7  
 % Actively Deferring: 23.00%

Total Annuity Assets: \$28,121.86  
 Average Contribution: \$1,077.14  
 Estimated Annual  
 Contributions: \$7,540.00  
 Approximate Taxes  
 Deferred Amount: \$0.00  
 Total Participation by Age:  
 0 - 25: 3.00  
 26 - 35: 2.00  
 36 - 45: 2.00  
 46 - 55: 1.00  
 56 - 65: 1.00  
 over 65: 0.00

Total Fixed: \$0.00  
 Total Fixed Percent: 0.00%  
 Total Variable: \$28,121.86  
 Total Variable Percent: 100.00%  
 Estimated Annualized  
 Life Insurance Prem: \$0.00  
 Total Life Policies: 0.00  
 Total Life Insurance  
 Death Benefit: \$0.00

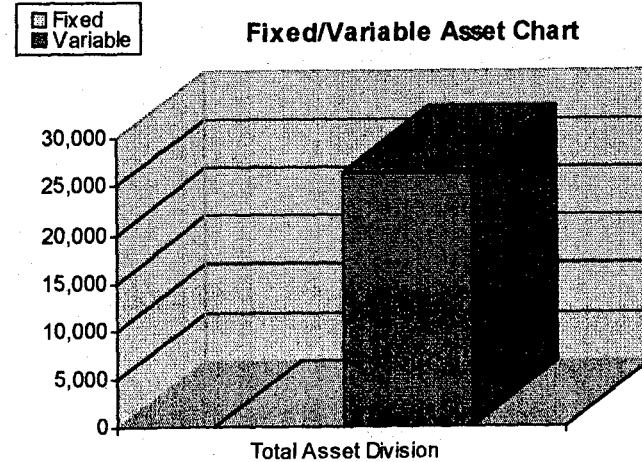
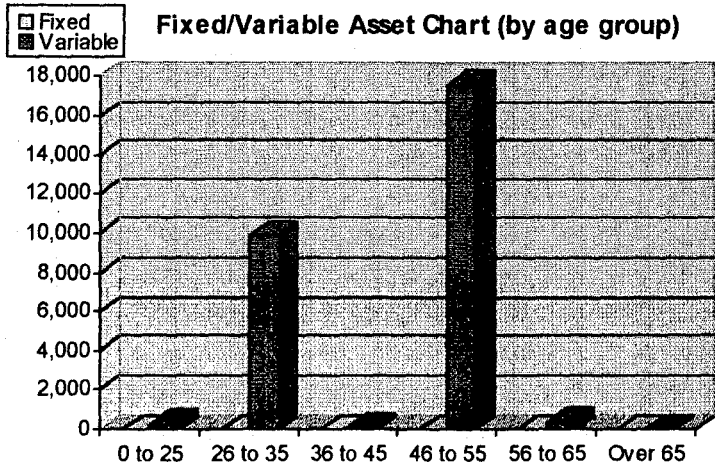



Entity Number - 652148  
 Name - TYLER COUNTY

Prepared by: Ted Lukeman  
 (281) 379-3083  
 Data as of: 2/4/00

Total Eligible: 124  
 Total in Plan: 21  
 Participants  
 Actively Deferring: 18  
 % Actively Deferring: 14.00%

Total Annuity Assets: \$233,080.15  
 Average Contribution: \$3,092.68  
 Estimated Annual  
 Contributions: \$55,668.20  
 Approximate Taxes  
 Deferred Amount: \$0.00  
 Total Participation by Age:  
 0 - 25: 0.00  
 26 - 35: 2.00  
 36 - 45: 4.00  
 46 - 55: 7.00  
 56 - 65: 7.00  
 over 65: 1.00

Total Fixed: \$96,524.37  
 Total Fixed Percent: 41.41%  
 Total Variable: \$136,555.78  
 Total Variable Percent: 58.59%  
 Estimated Annualized  
 Life Insurance Prem: \$0.00  
 Total Life Policies: 0.00  
 Total Life Insurance  
 Death Benefit: \$0.00

